

Installation Manual

PART NUMBER(S)		Model Year
TESS 1539 SE	TESS 1639 SE+	FORD MAVERICK 2022+
Cab(s)		Installation Time / Weight
SuperCrew		40-60 minutes / 53-57 kg

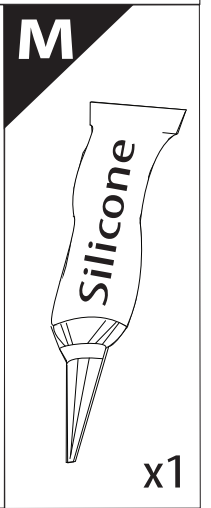

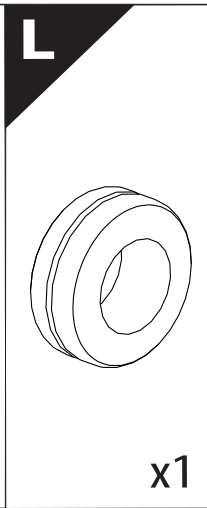

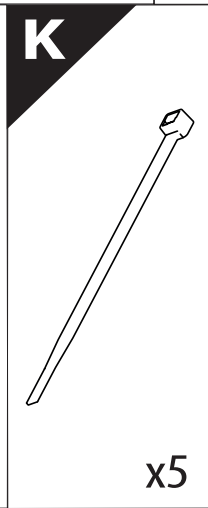
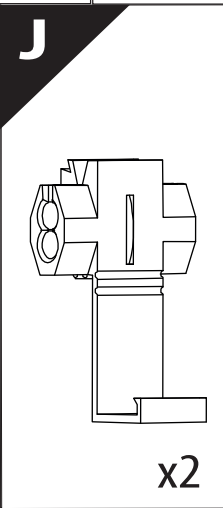
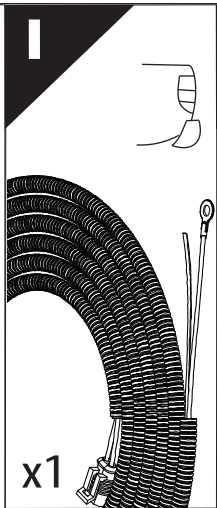
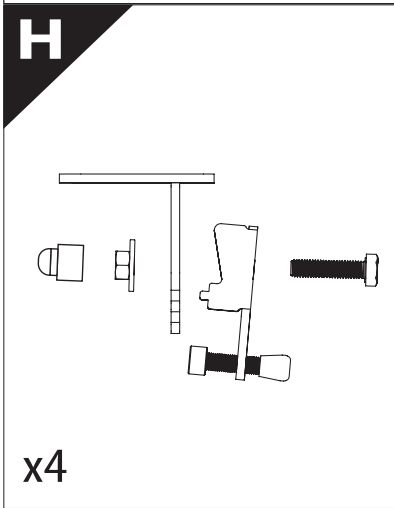
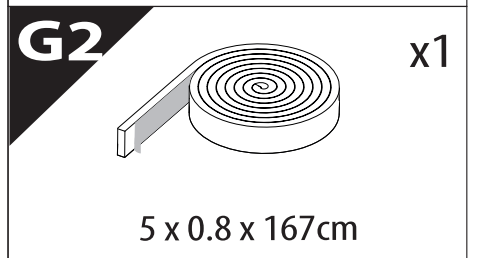
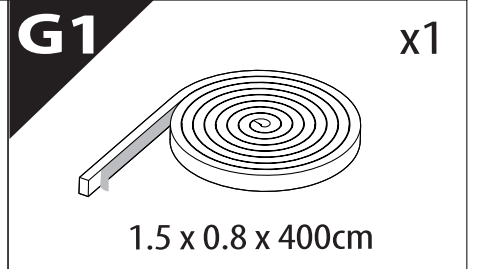
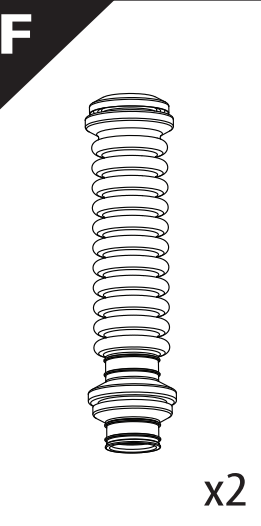
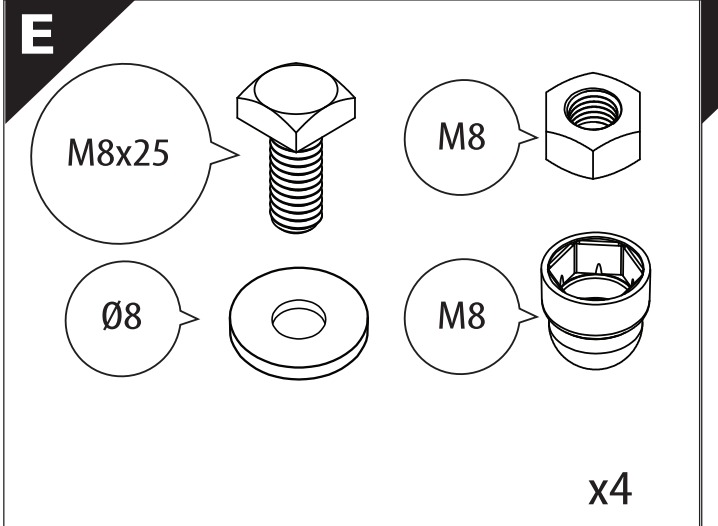
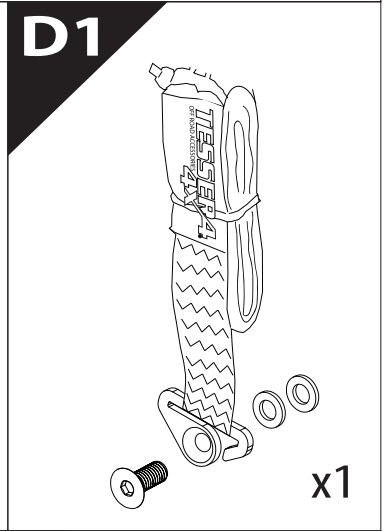
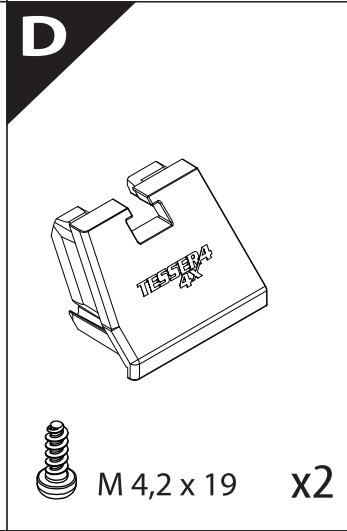
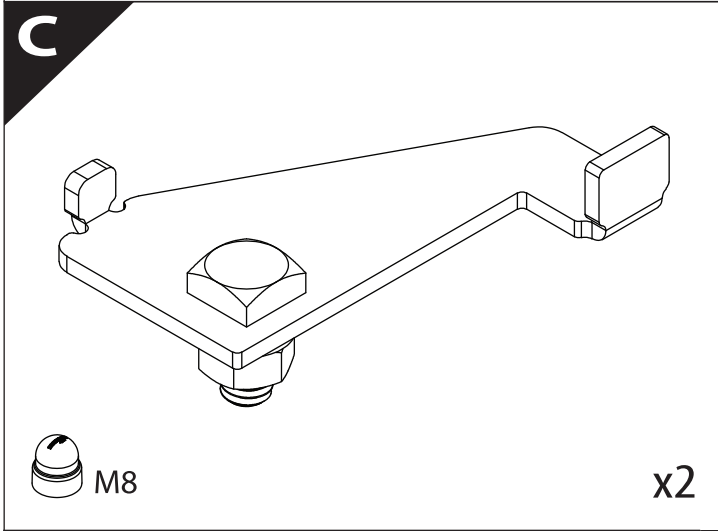
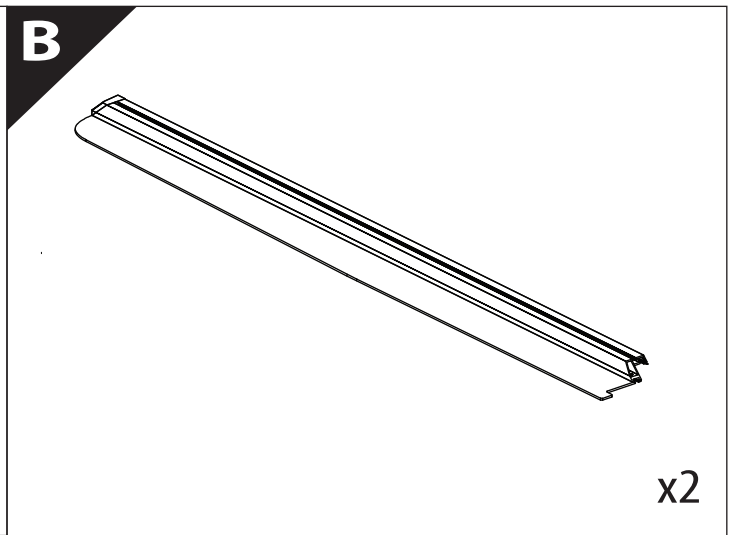
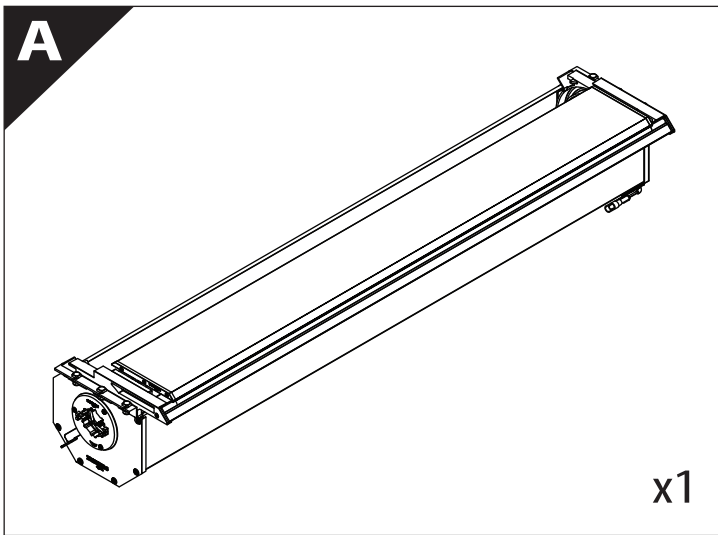
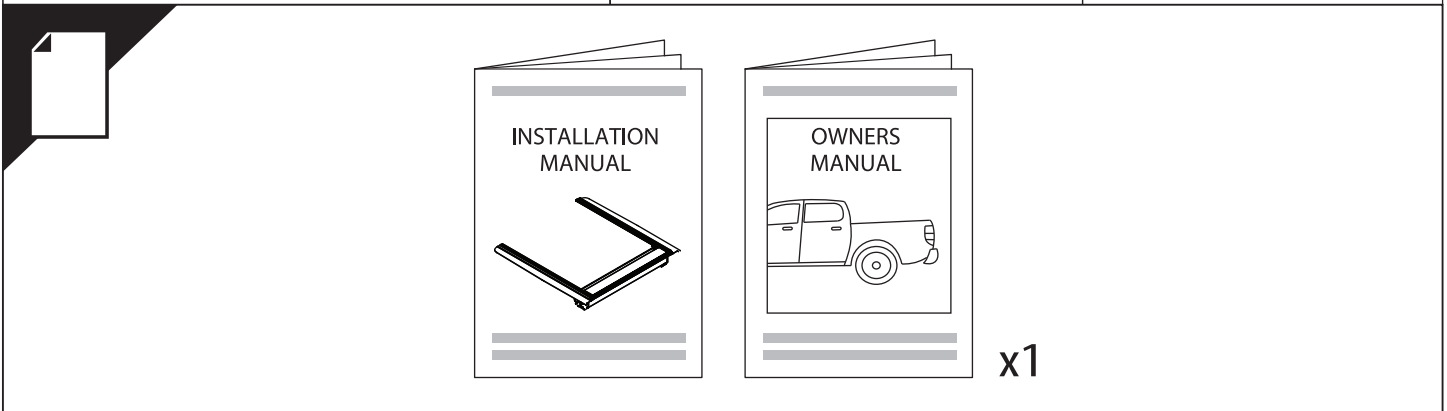
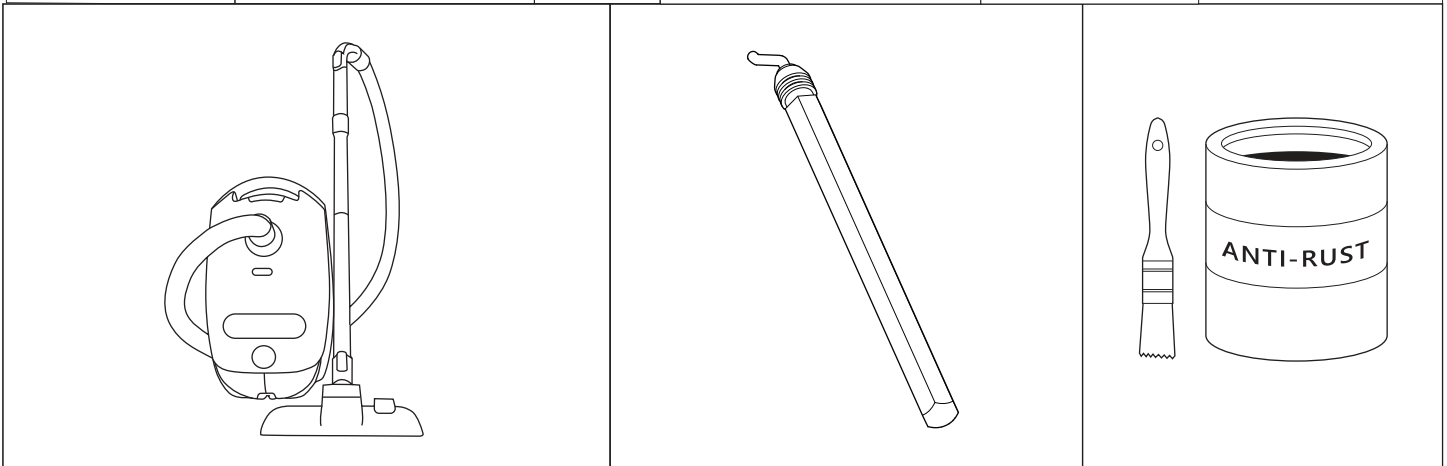
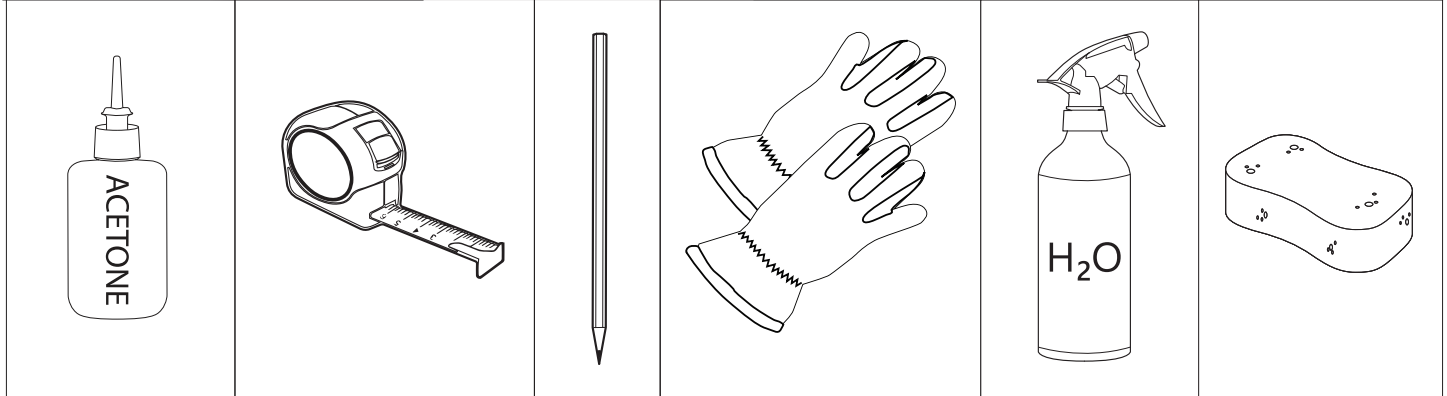
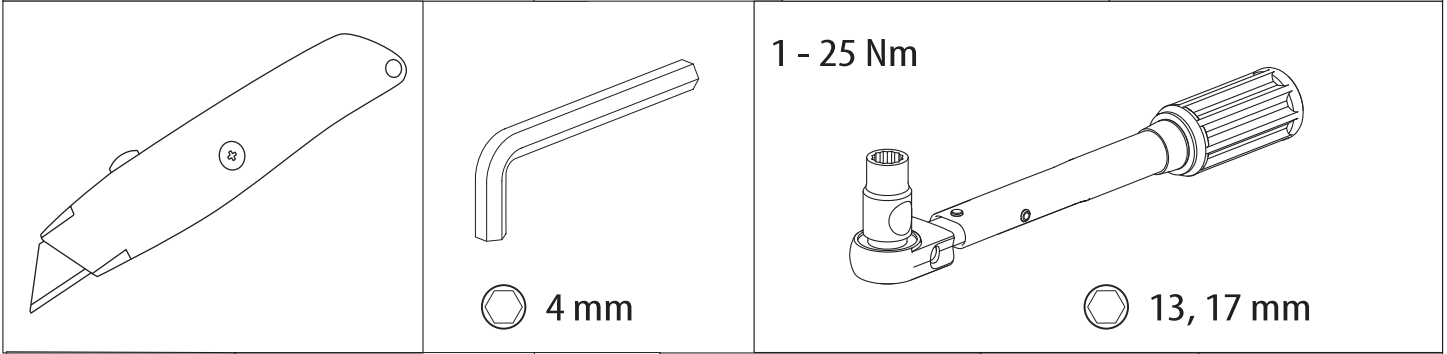
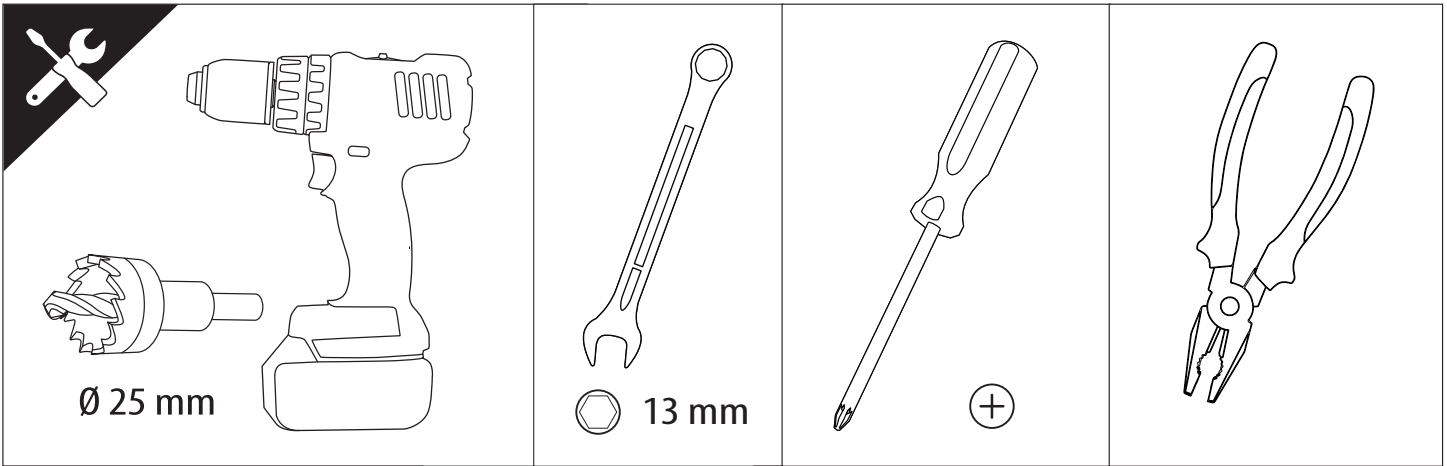
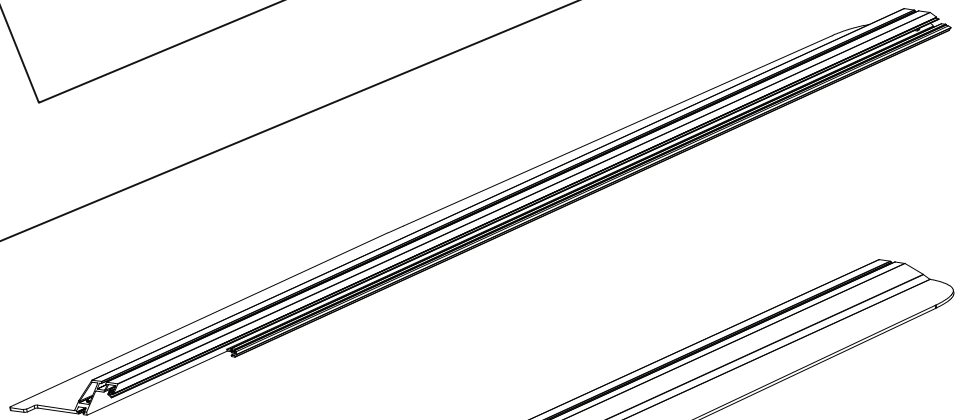
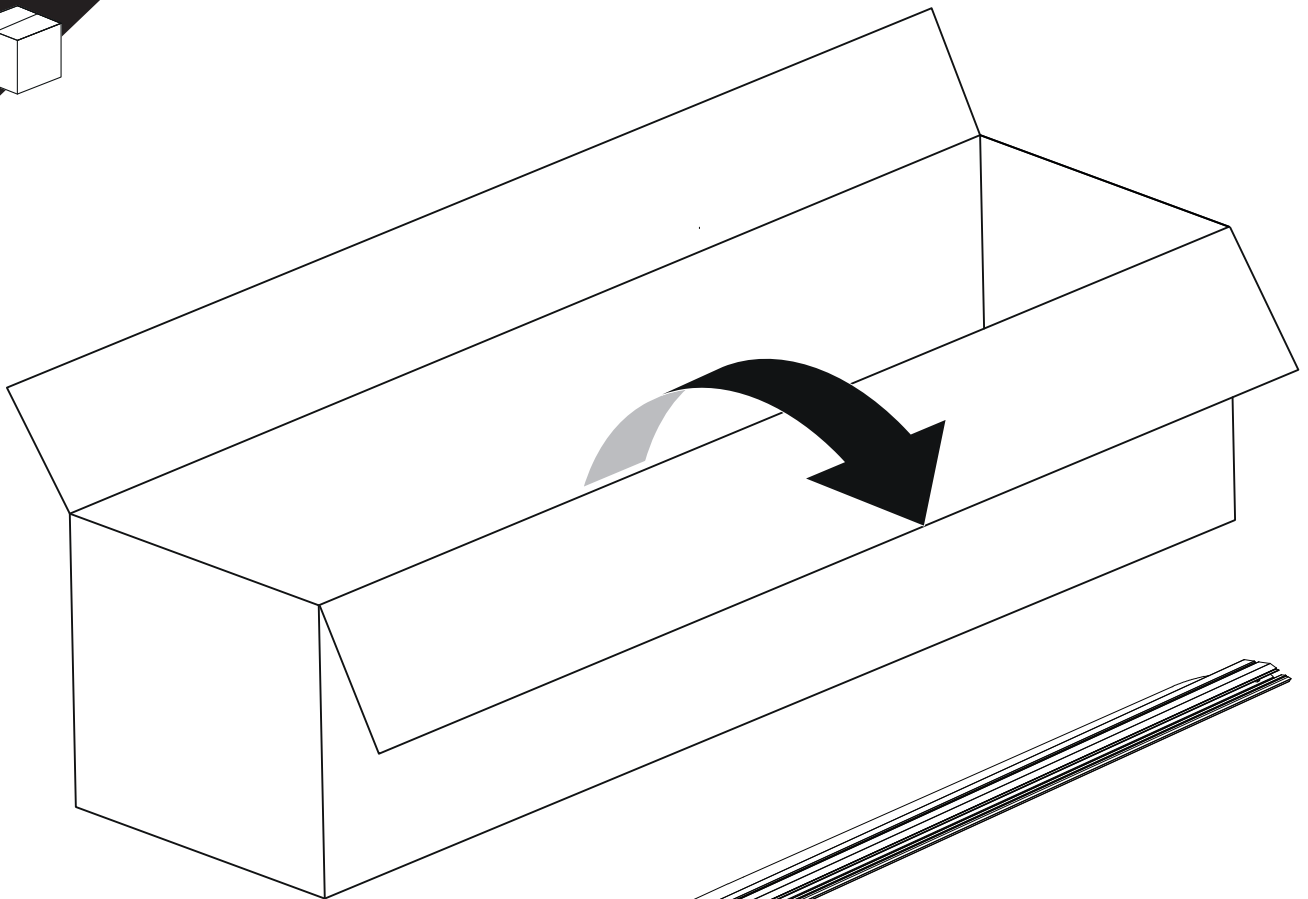

B

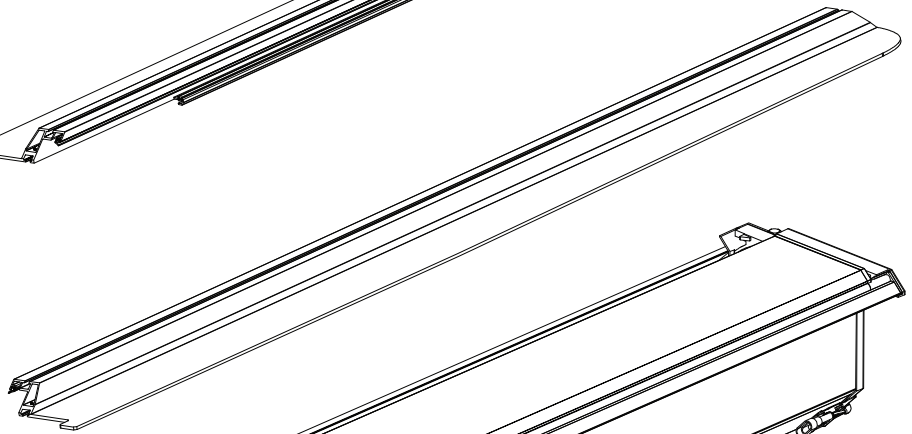

A

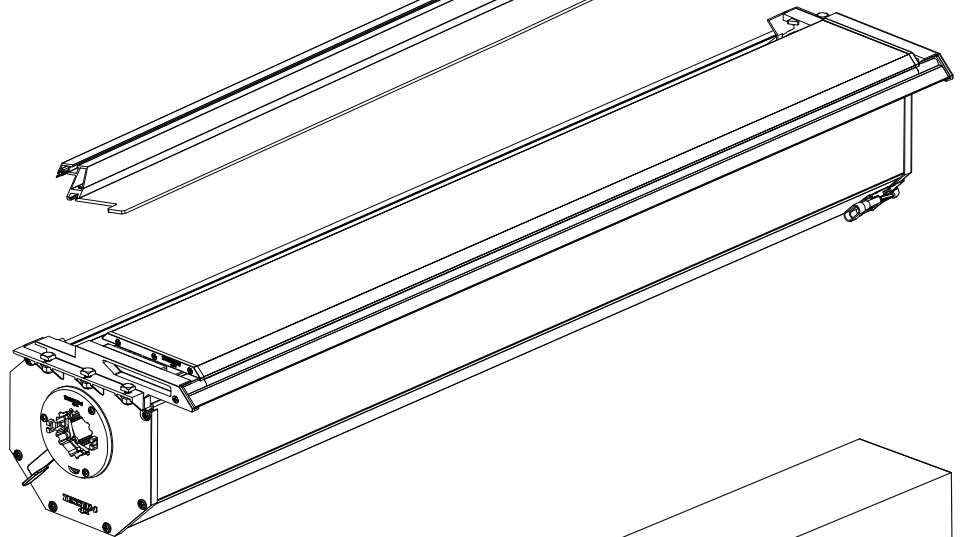

KITS

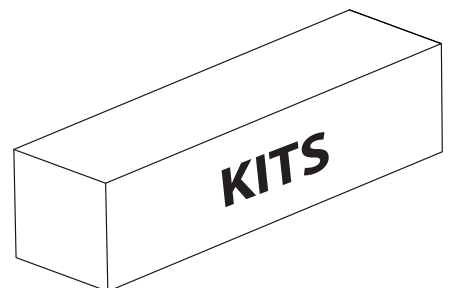

G

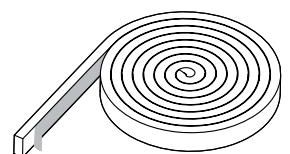

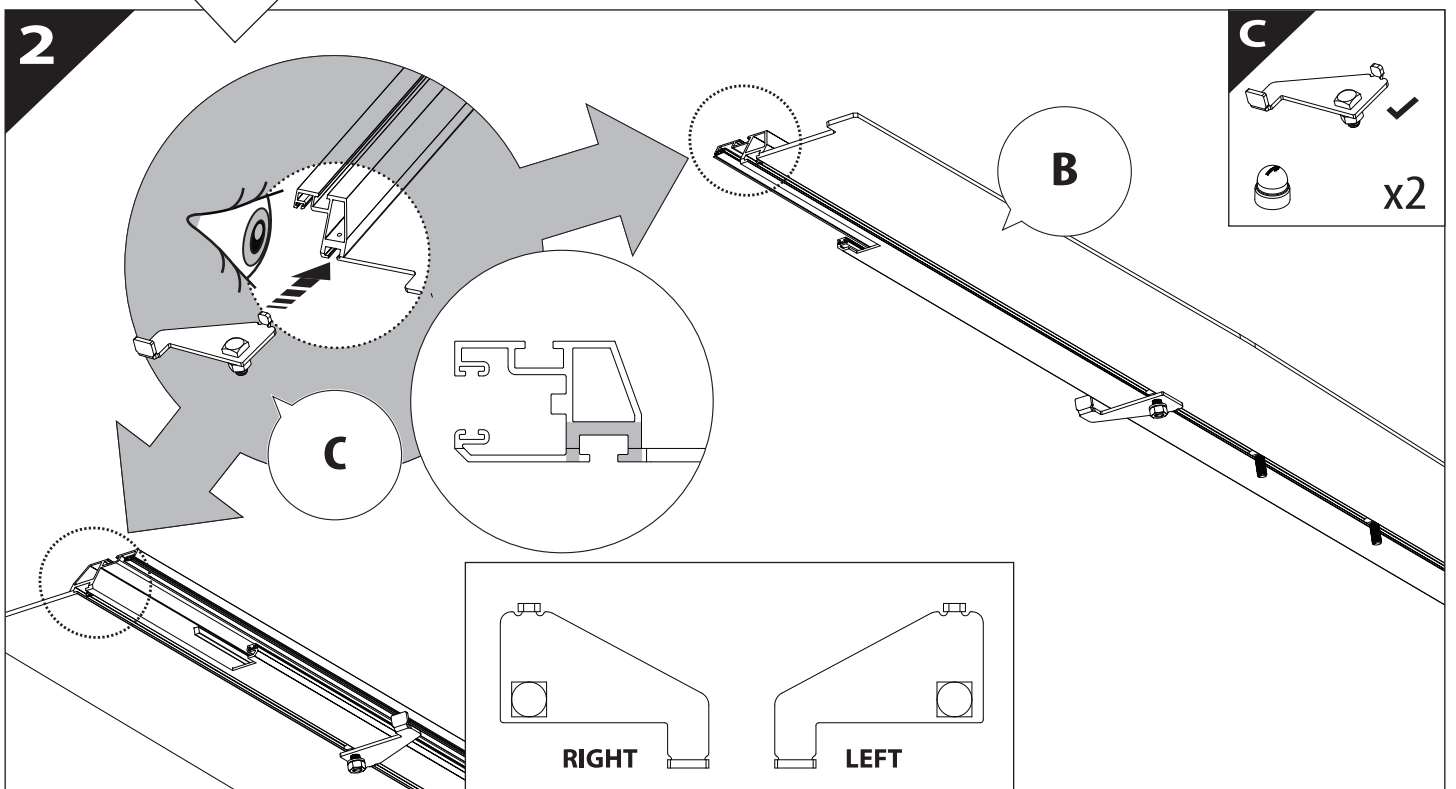
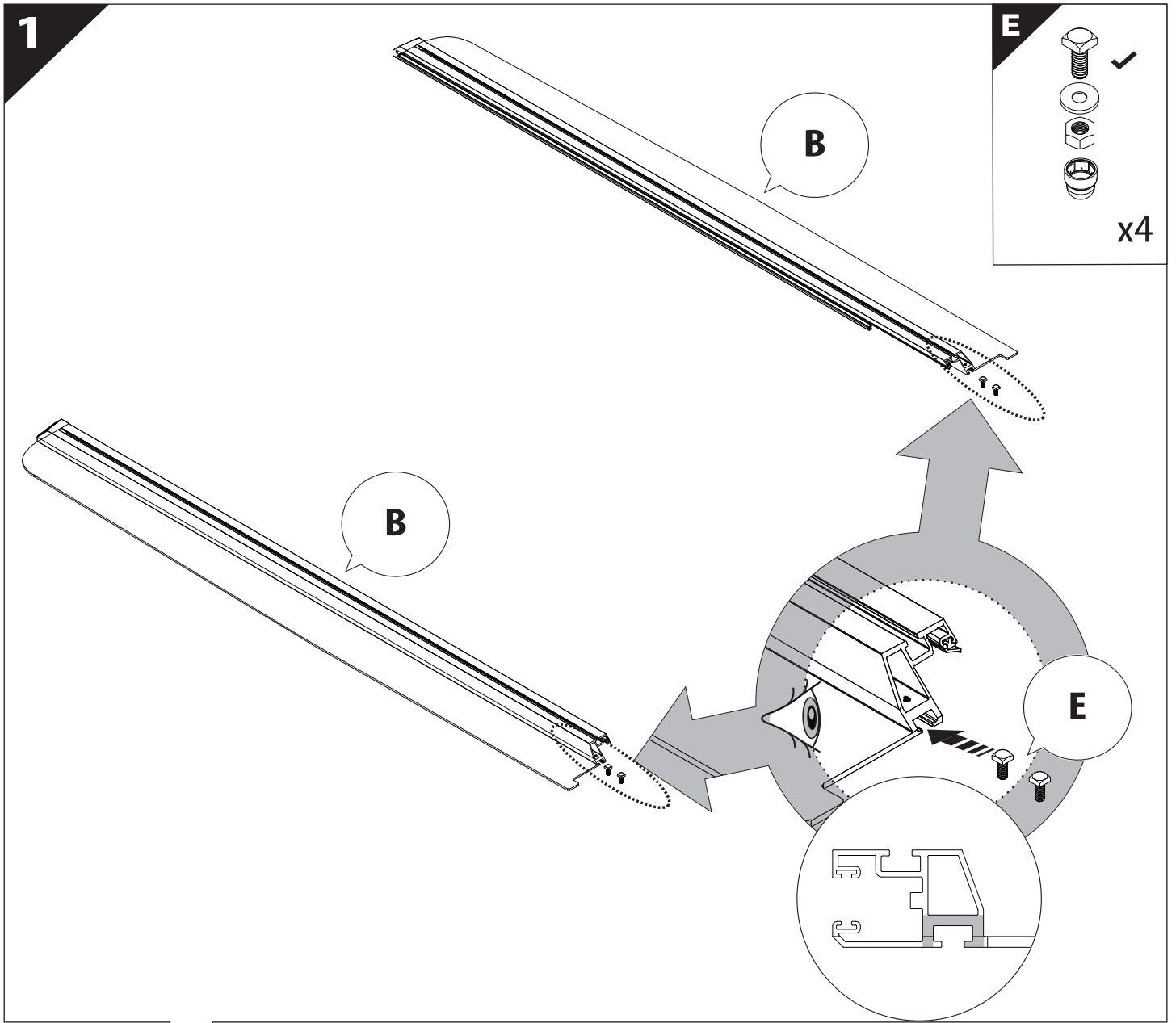

3

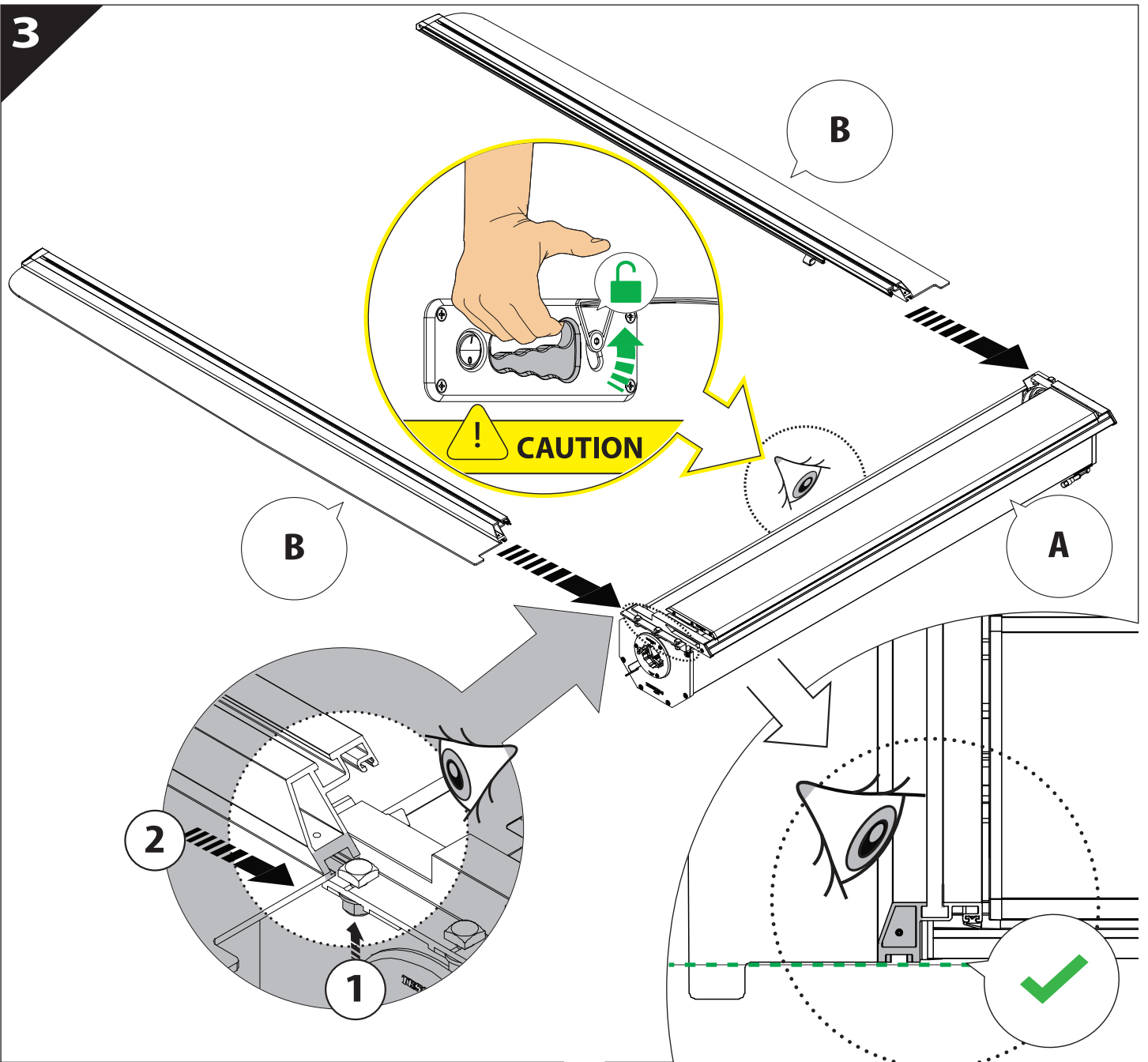

4

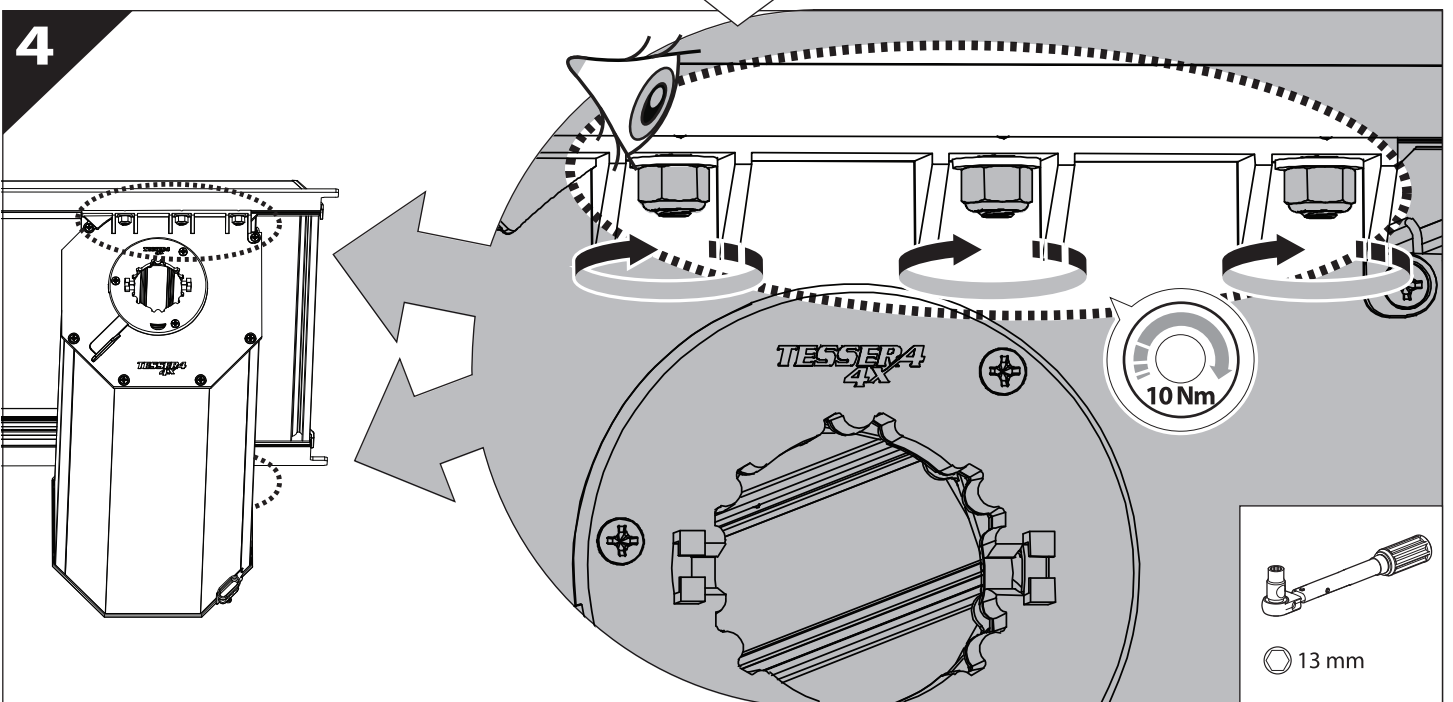

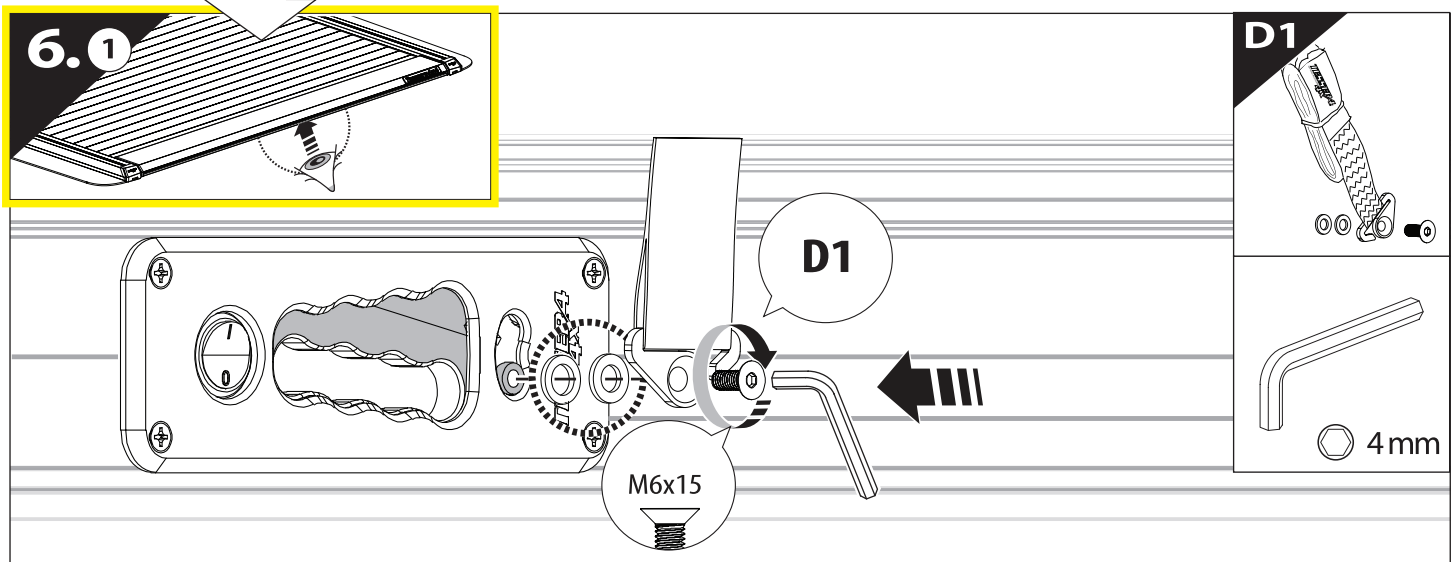
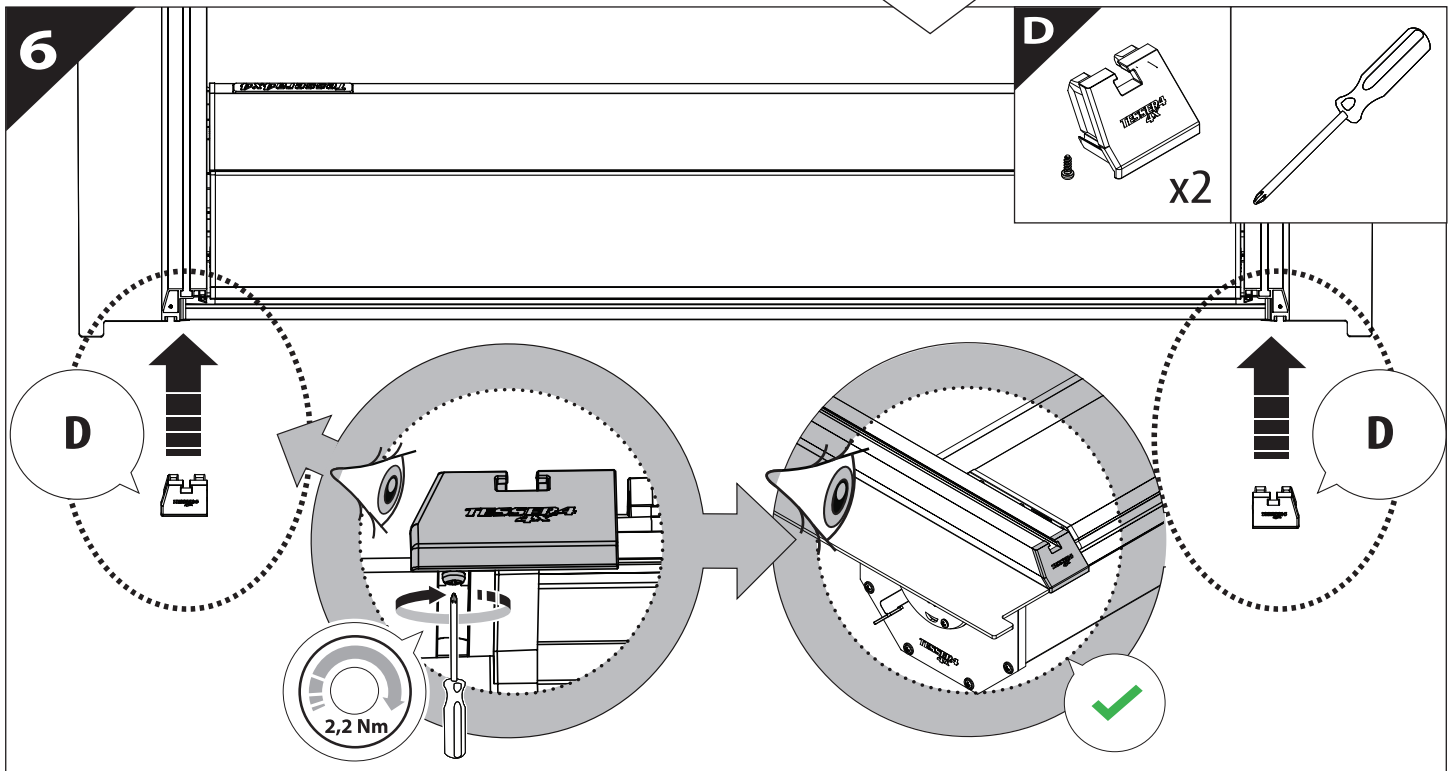
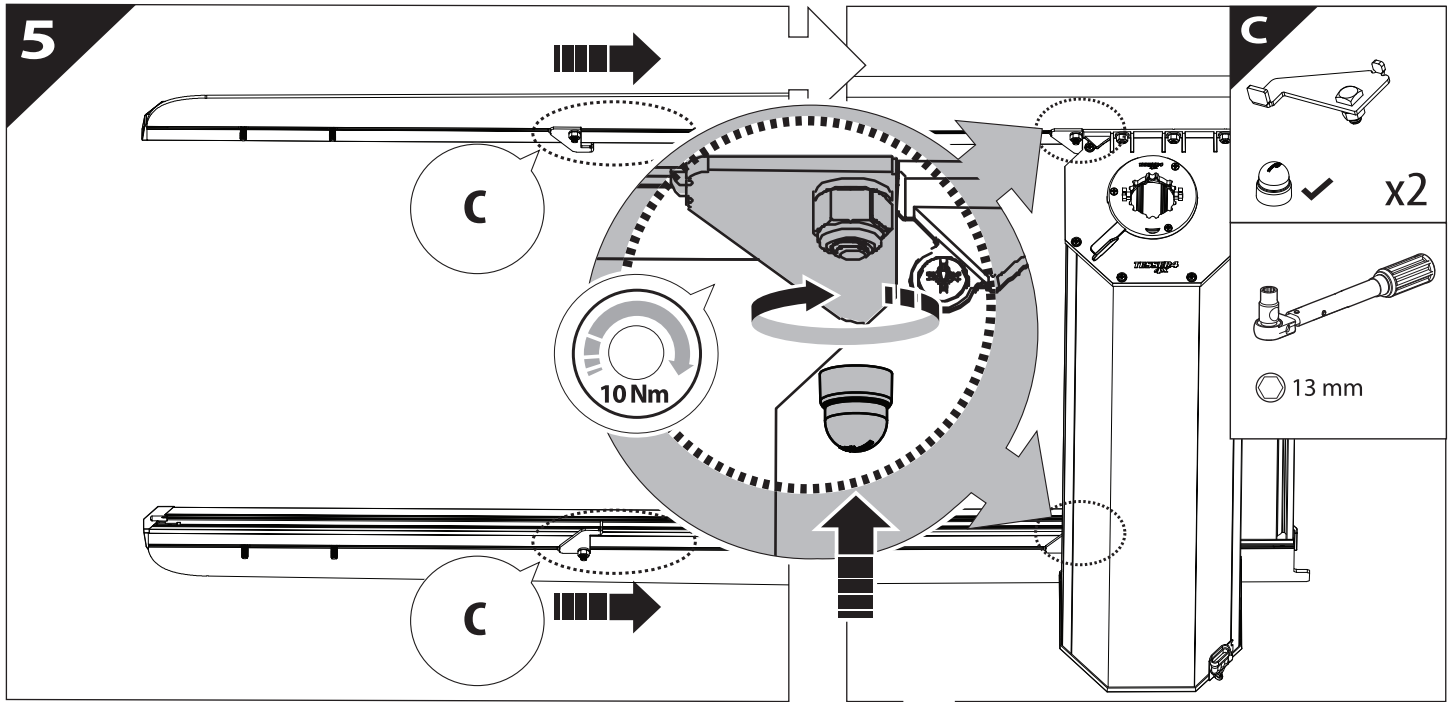

7

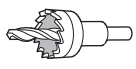
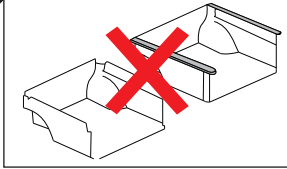

Ø 25 mm



Rust Protection

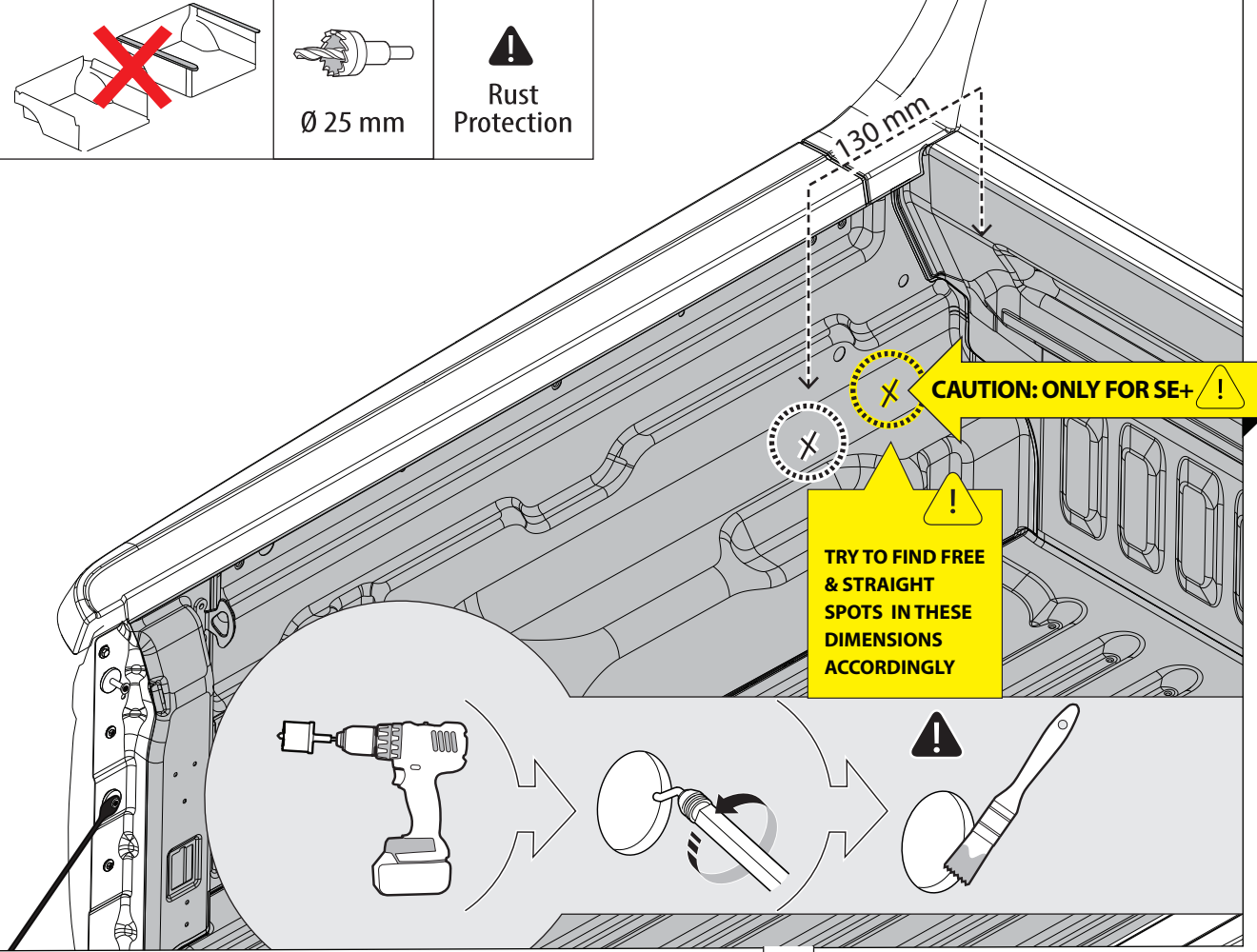

7.1

1

2

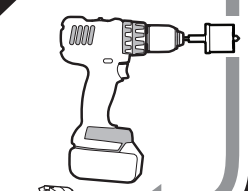

Ø 40 mm

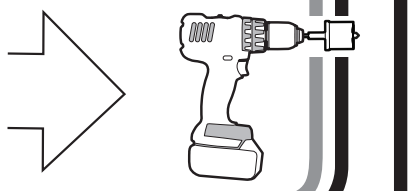

Ø 25 mm

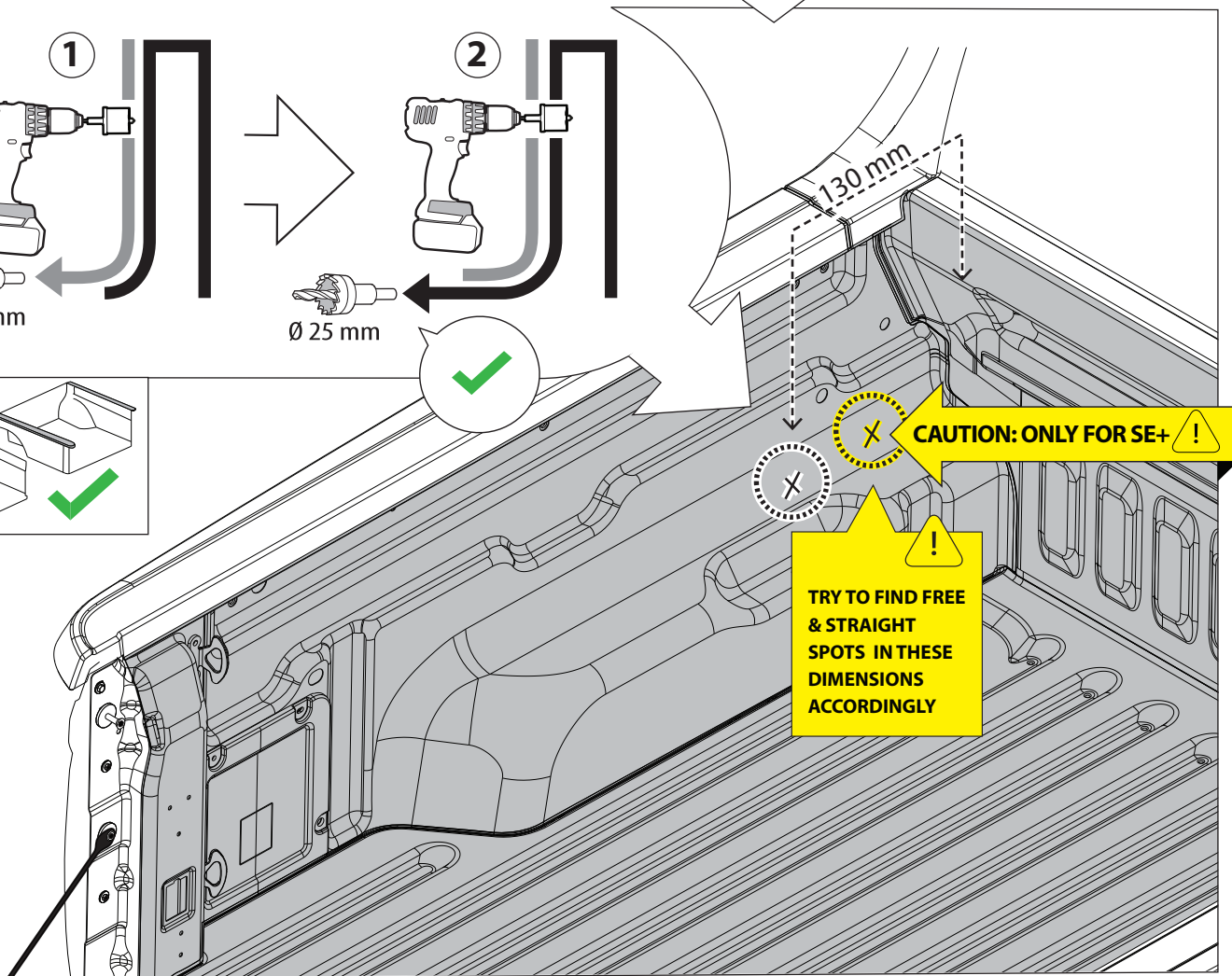
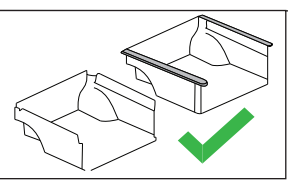

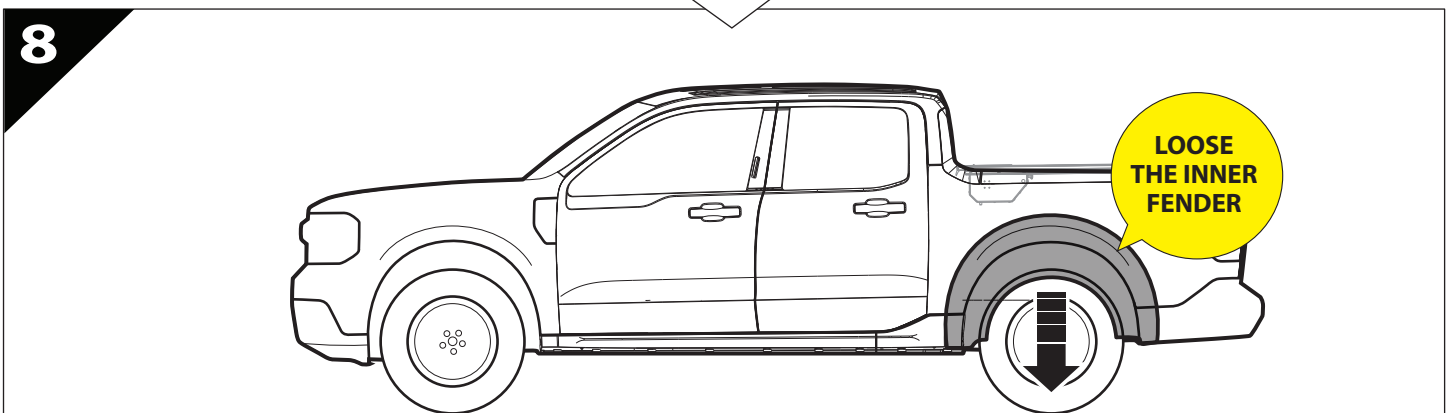
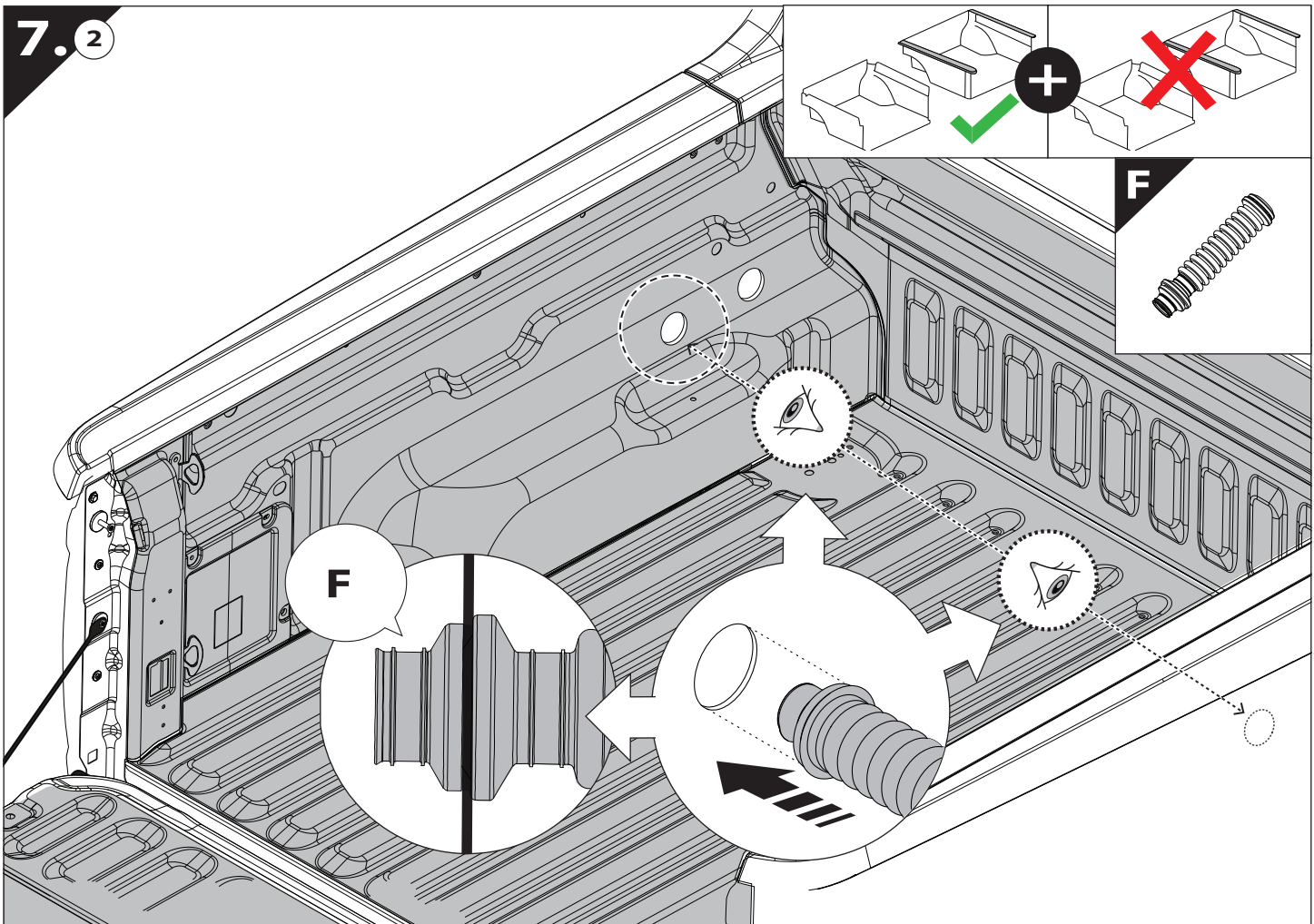

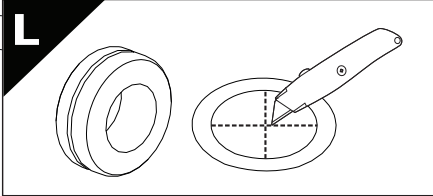
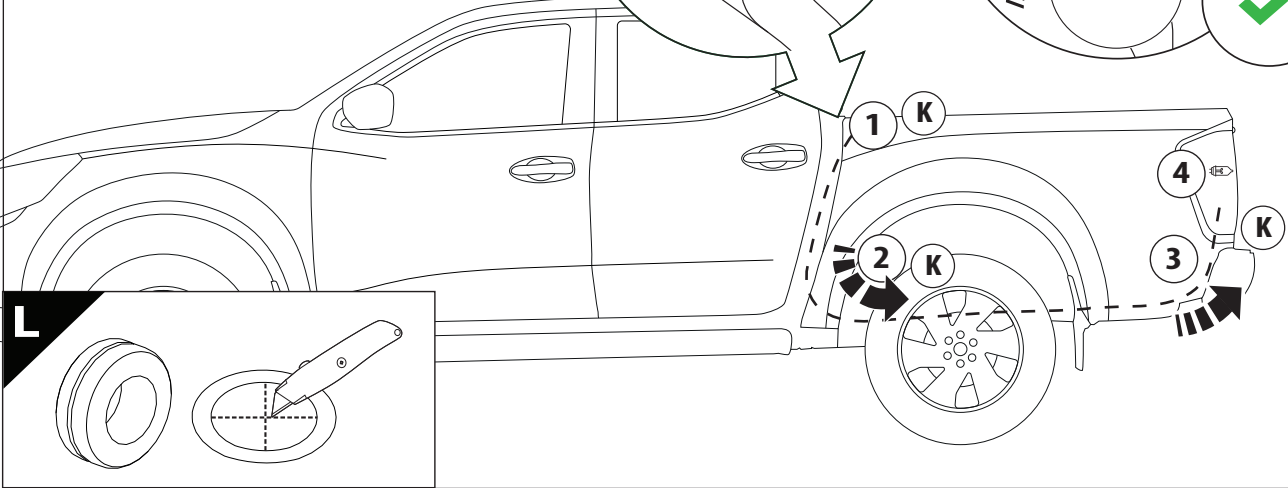
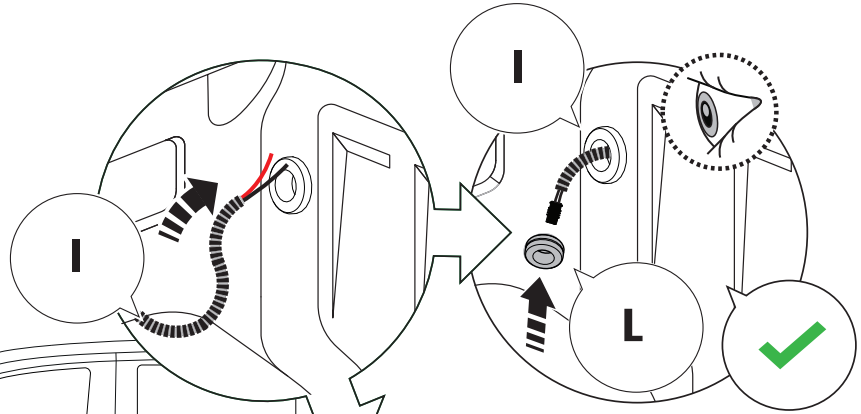
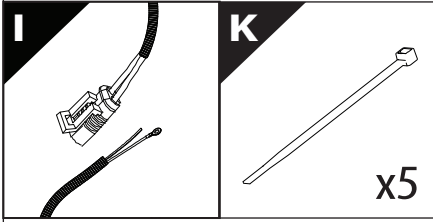

10

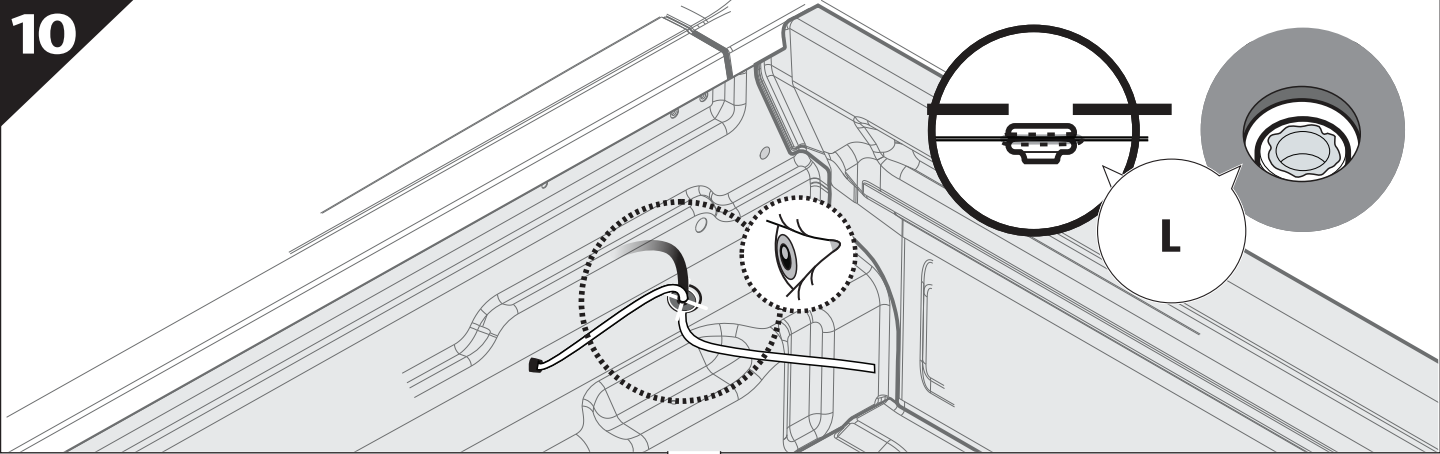

11

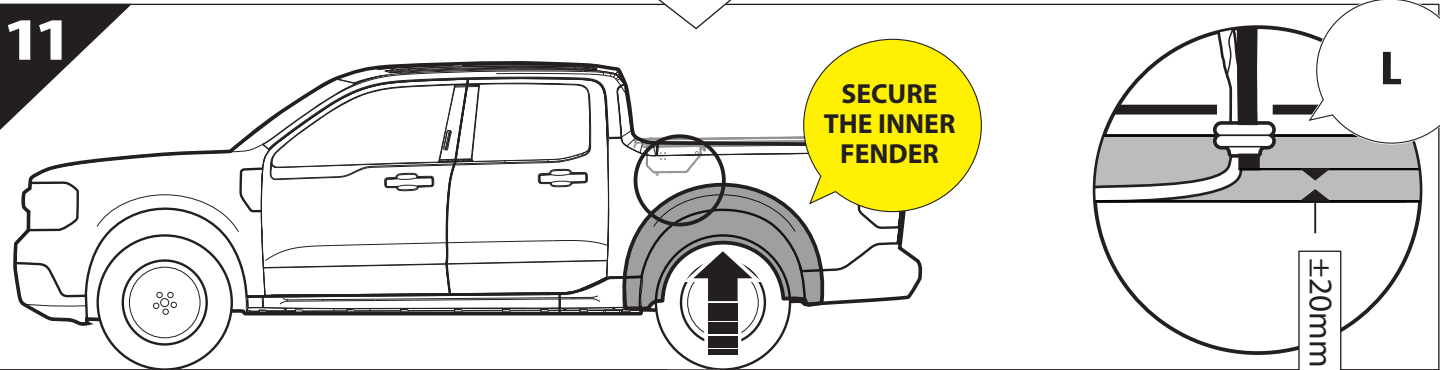

12

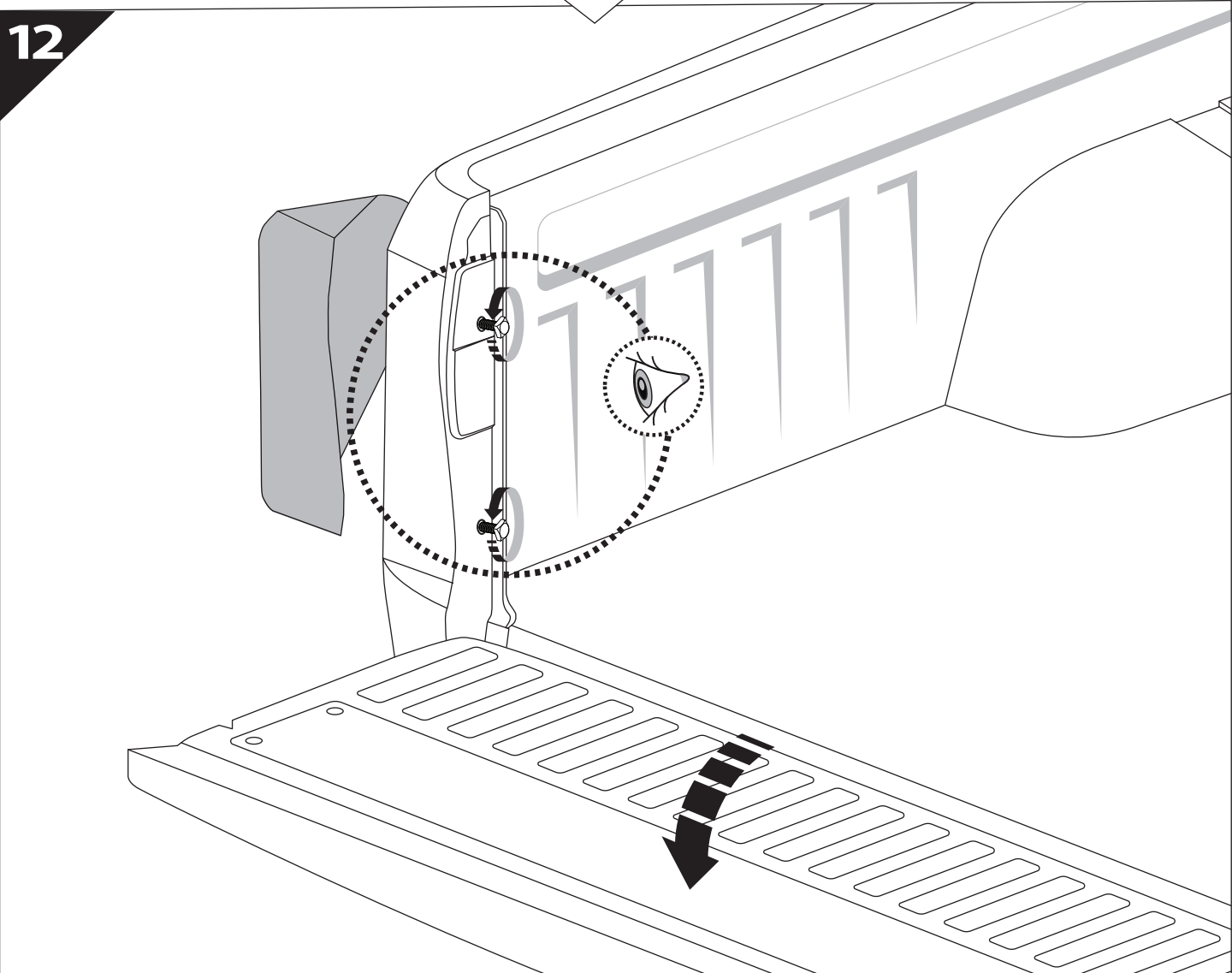

13

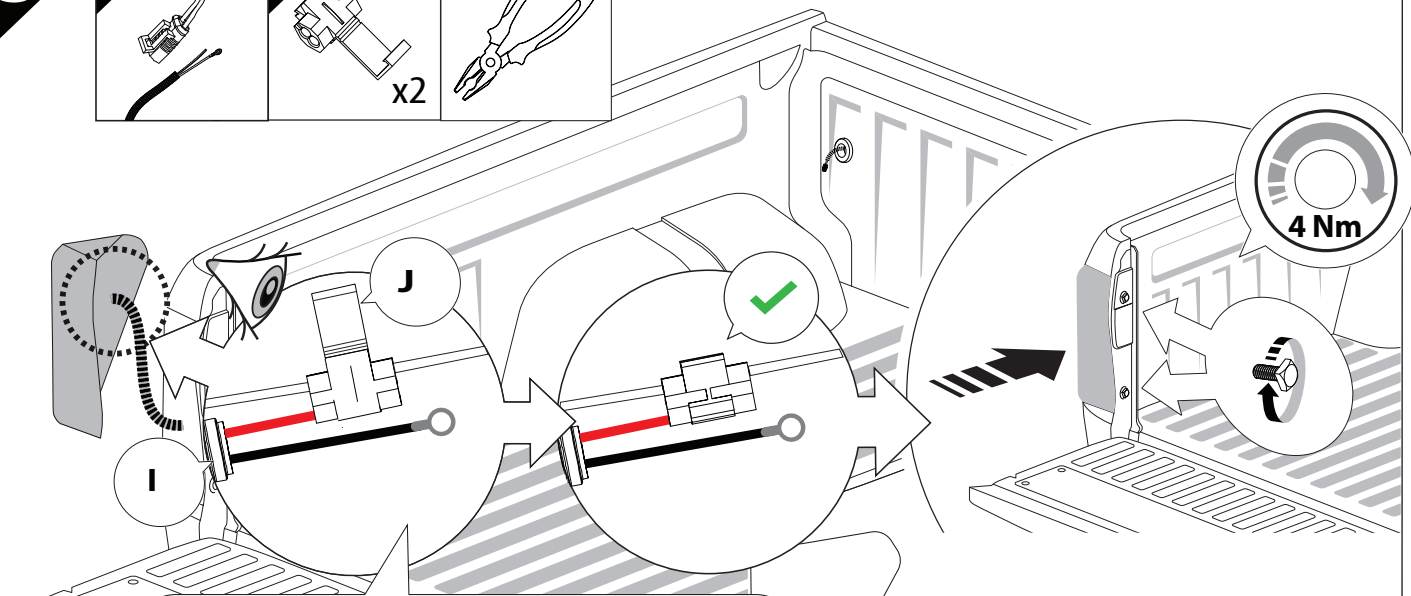
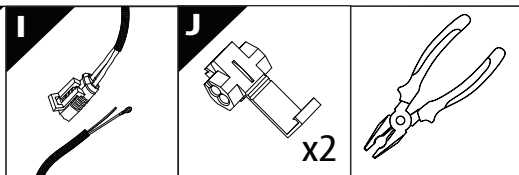

	CAR	TESSERA SE+
BEAM:	LIGHT SIGNAL ↔	
		OR
BRAKE:	LIGHT SIGNAL ↔	

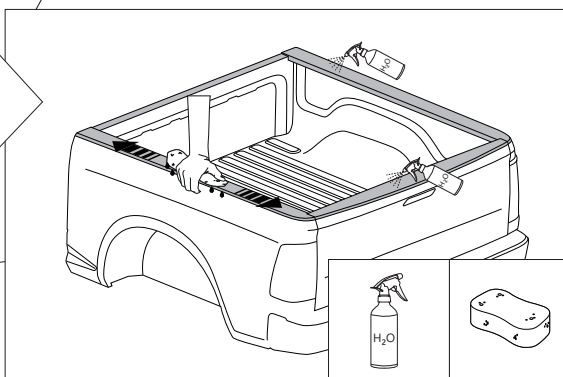

CONSULT YOUR VEHICLE ENGINEER OR A QUALIFIED ELECTRICIAN TO LOCATE AND CONNECT THE GROUND WIRE.

13.1

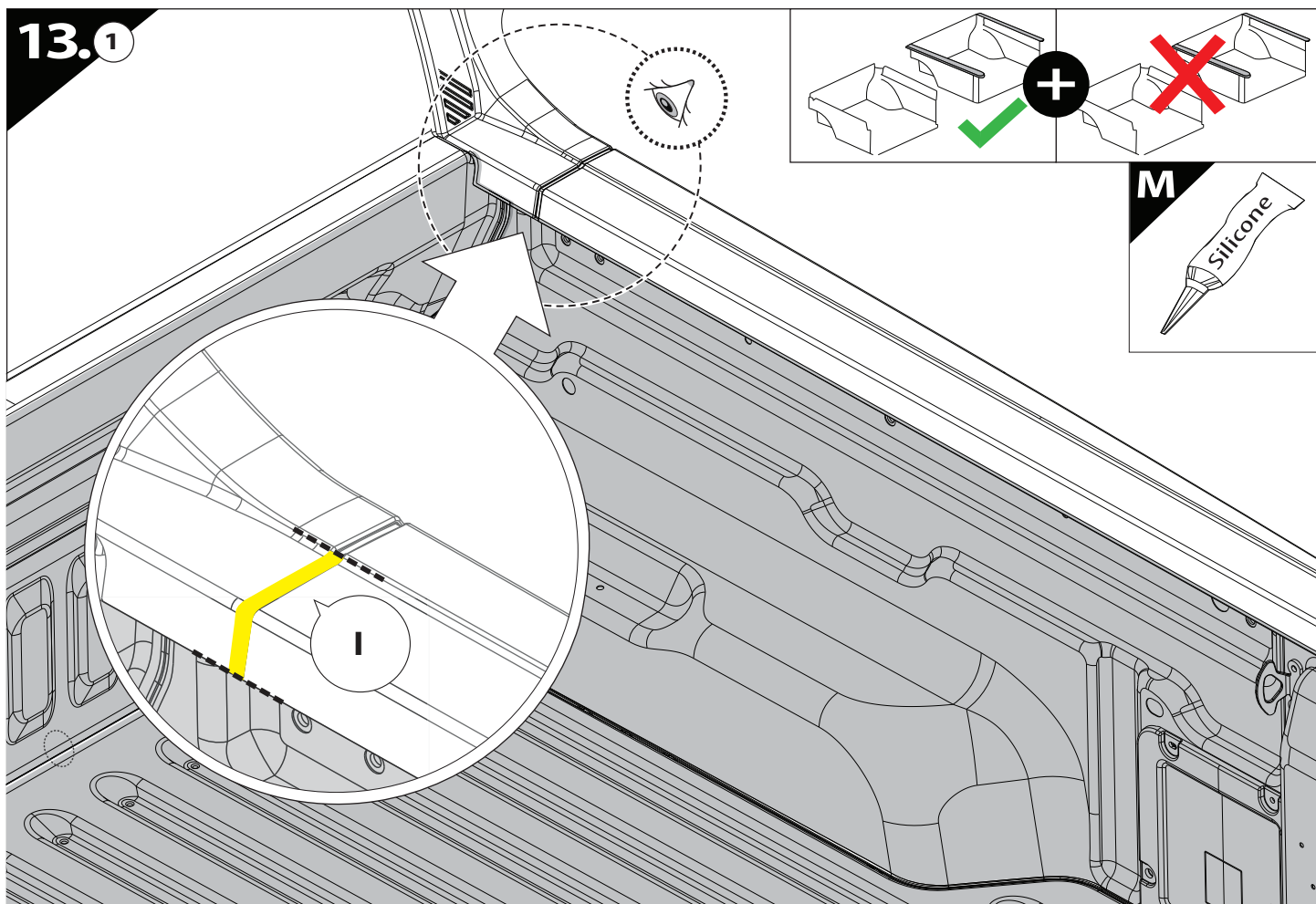

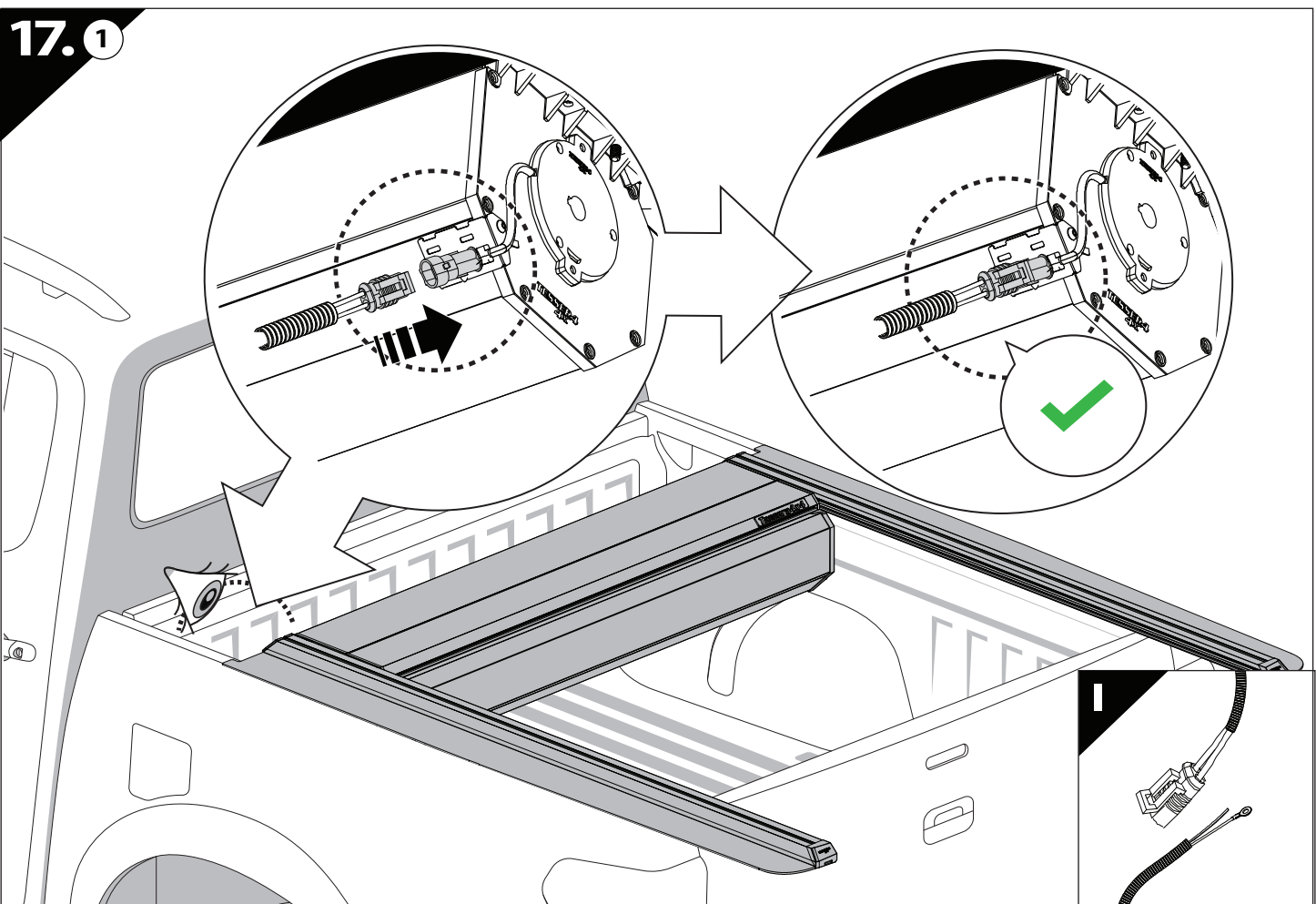
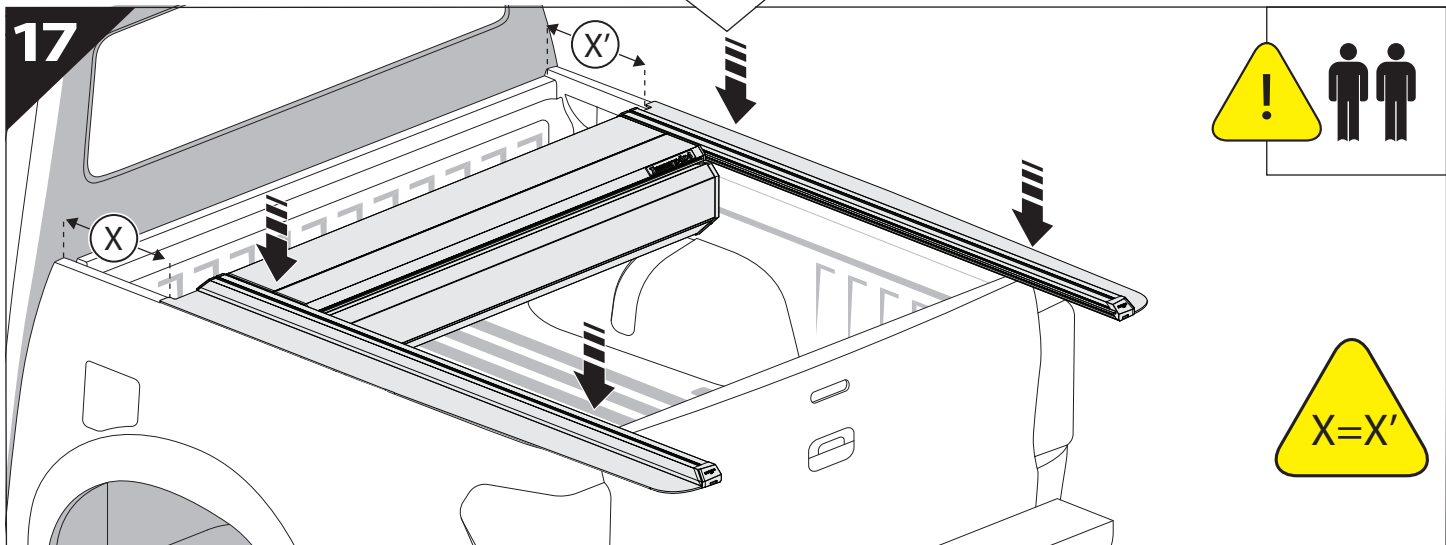
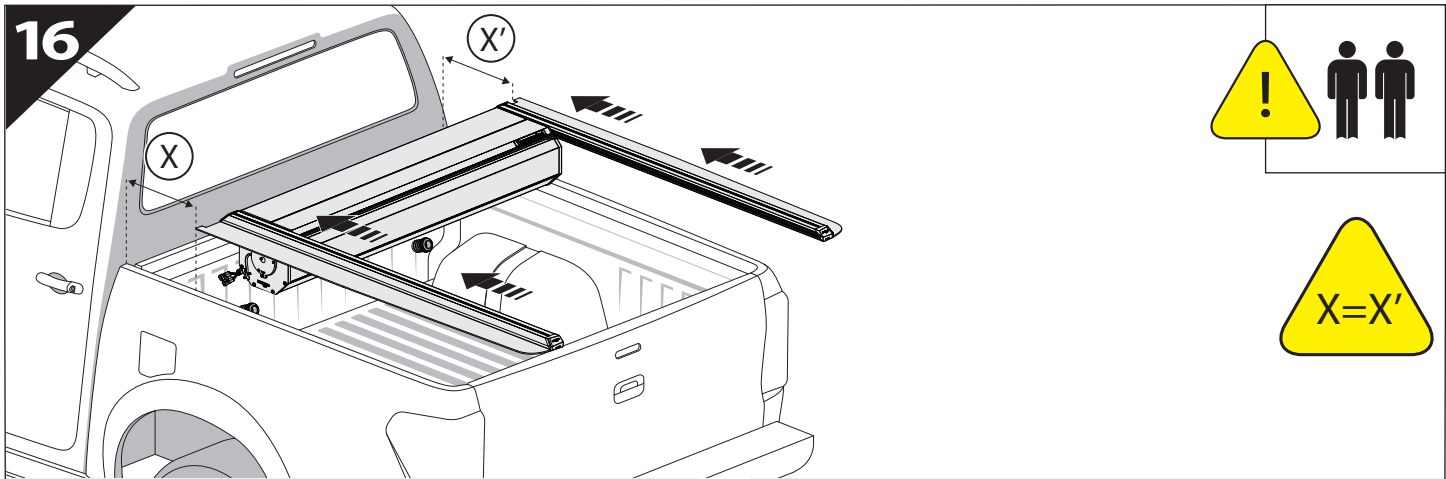

18

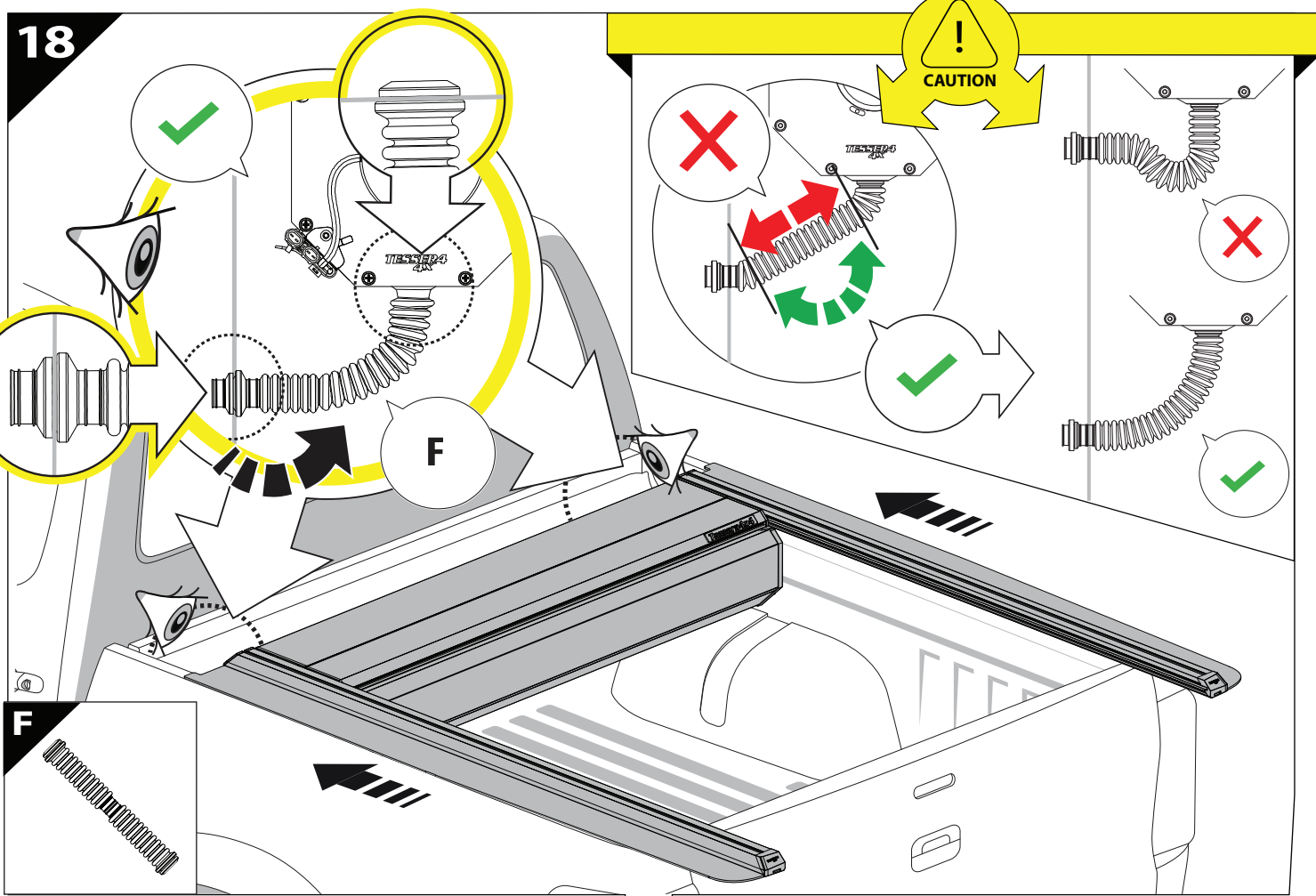

19

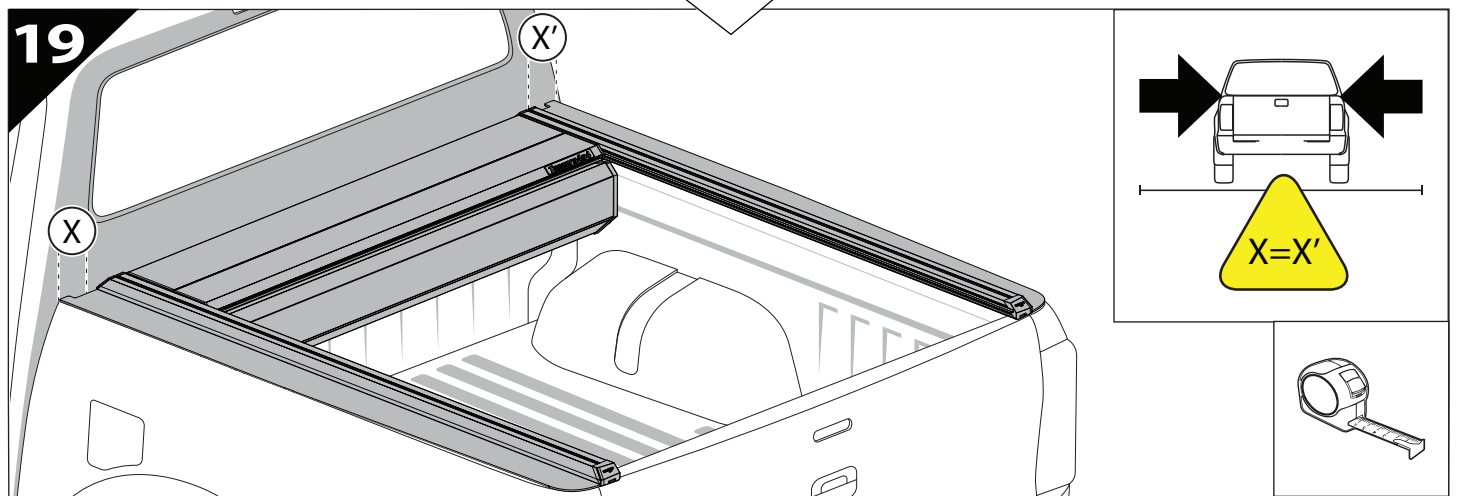

20

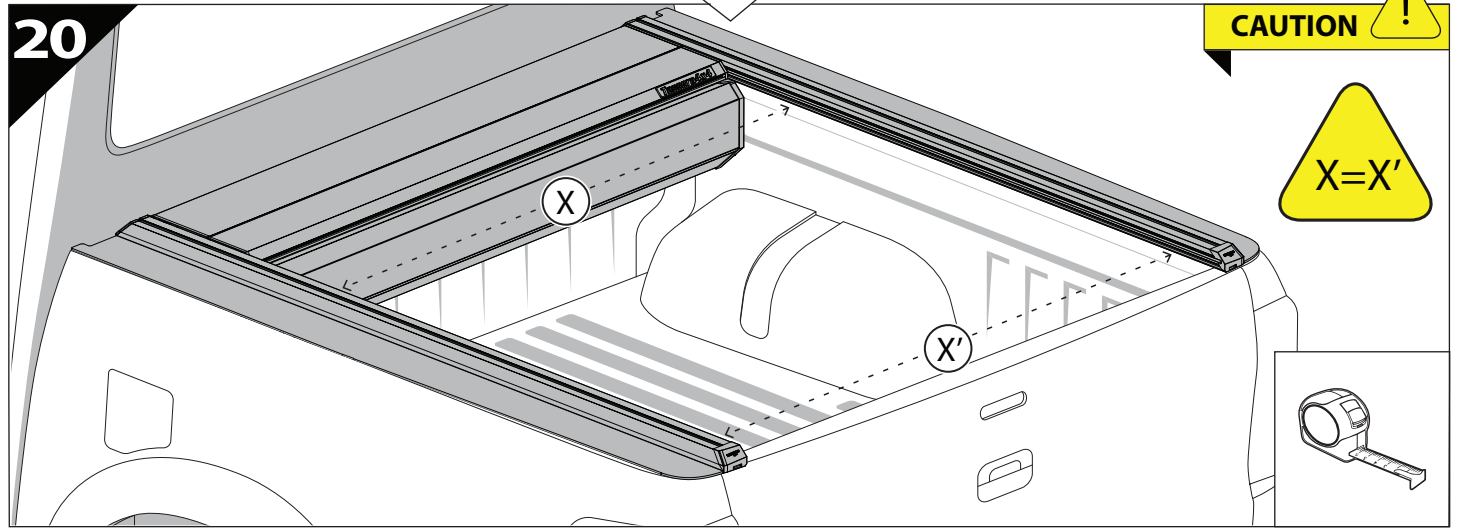

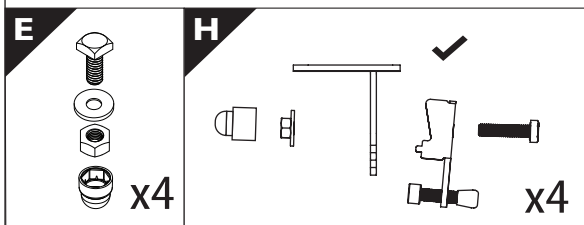
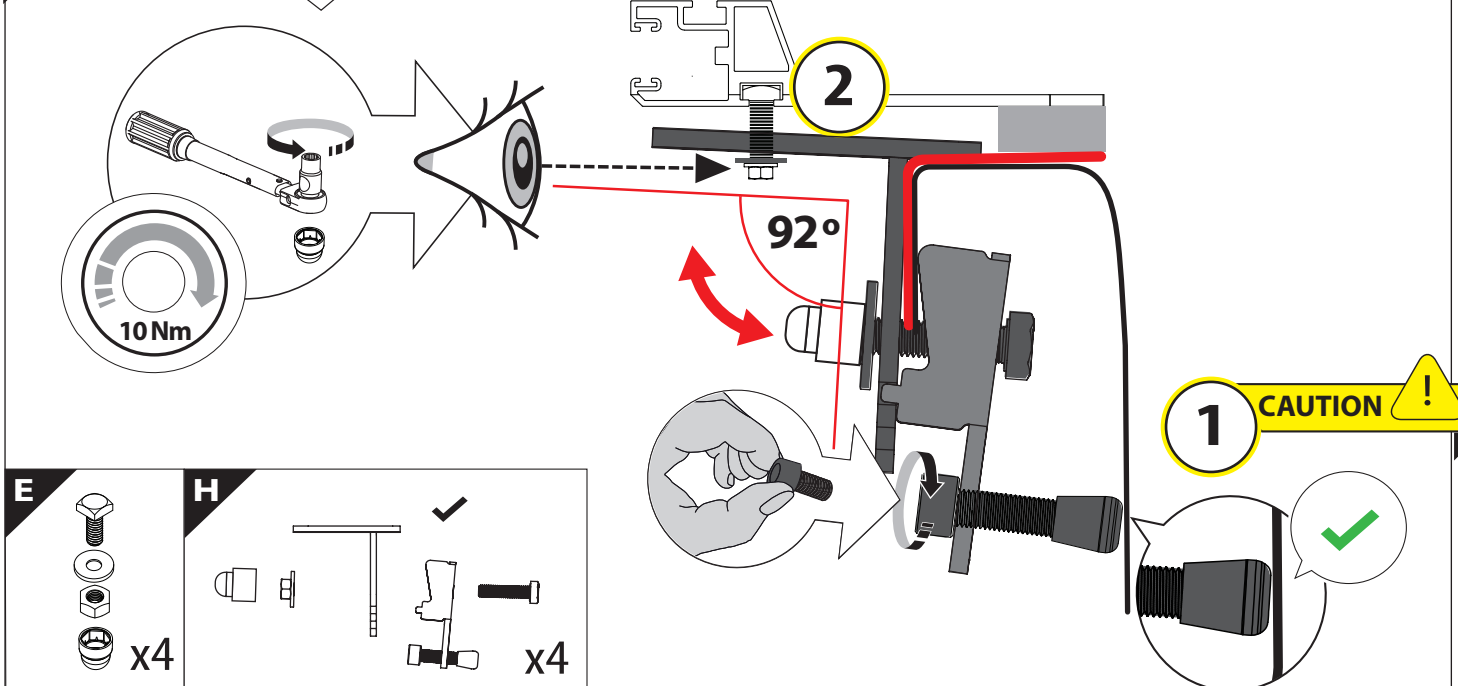
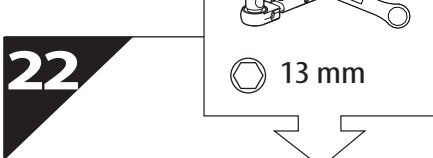
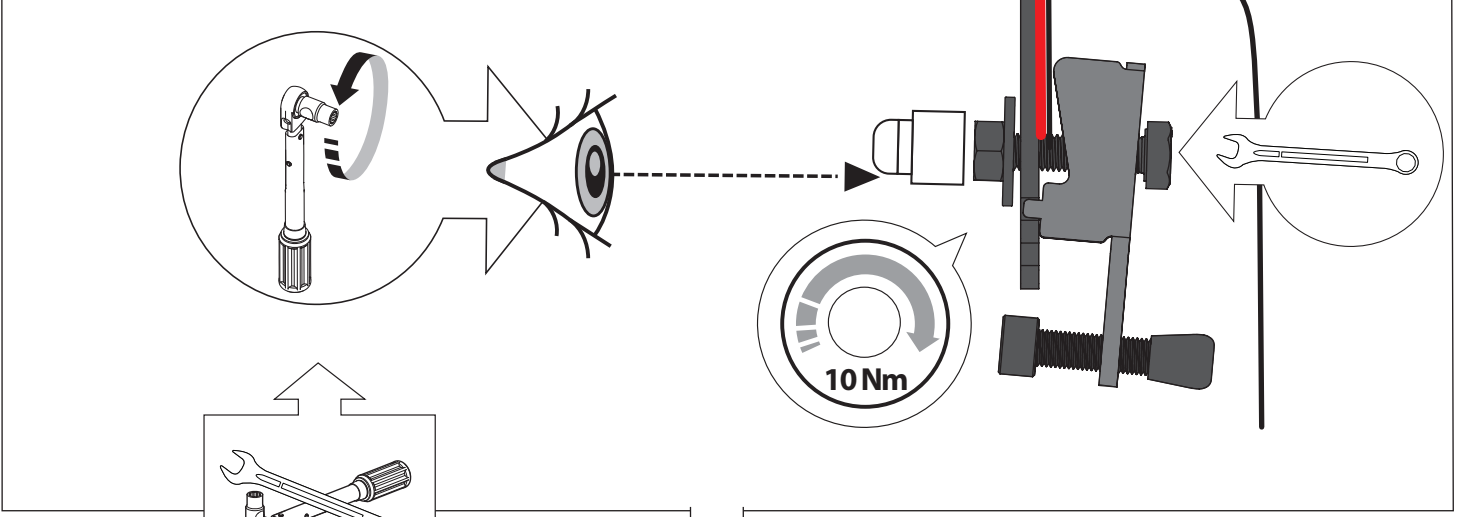
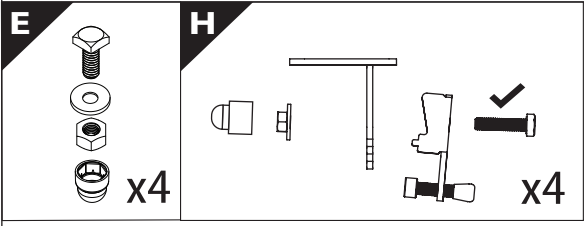
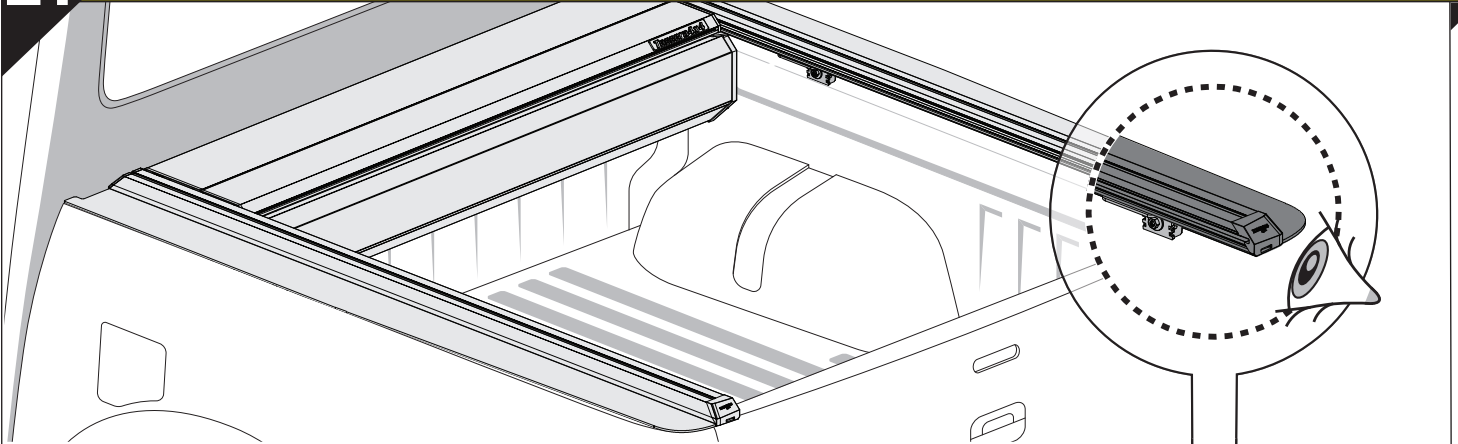

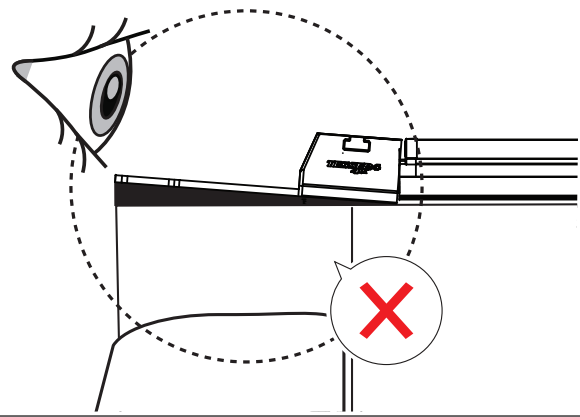
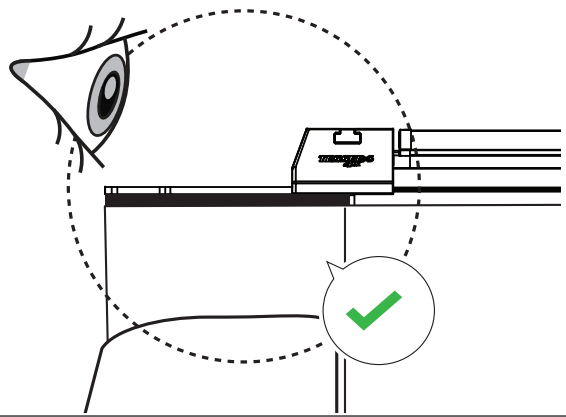
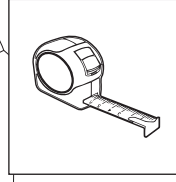
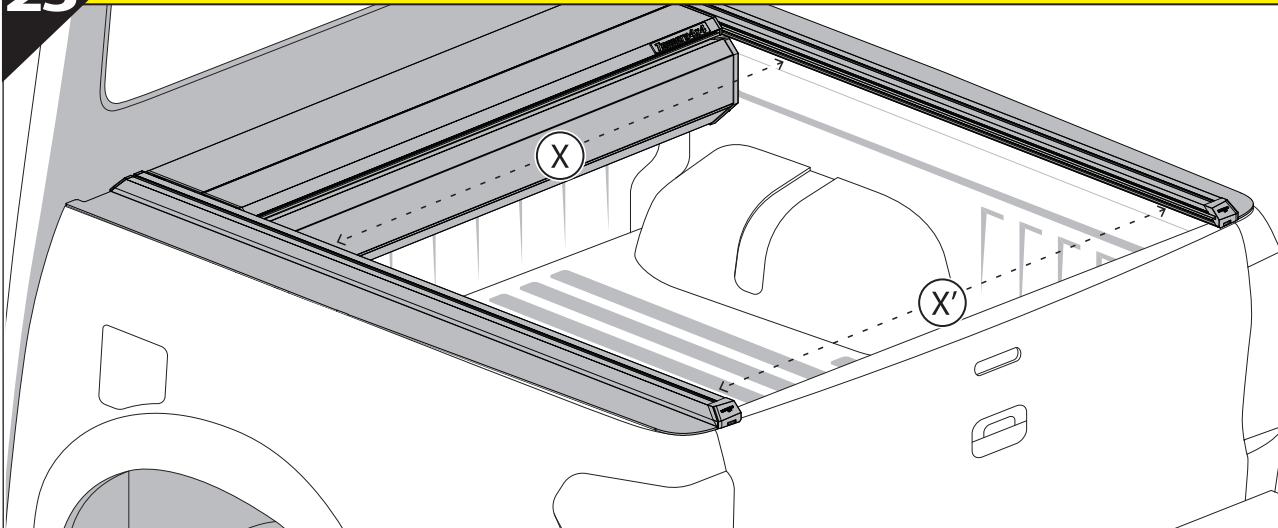

24

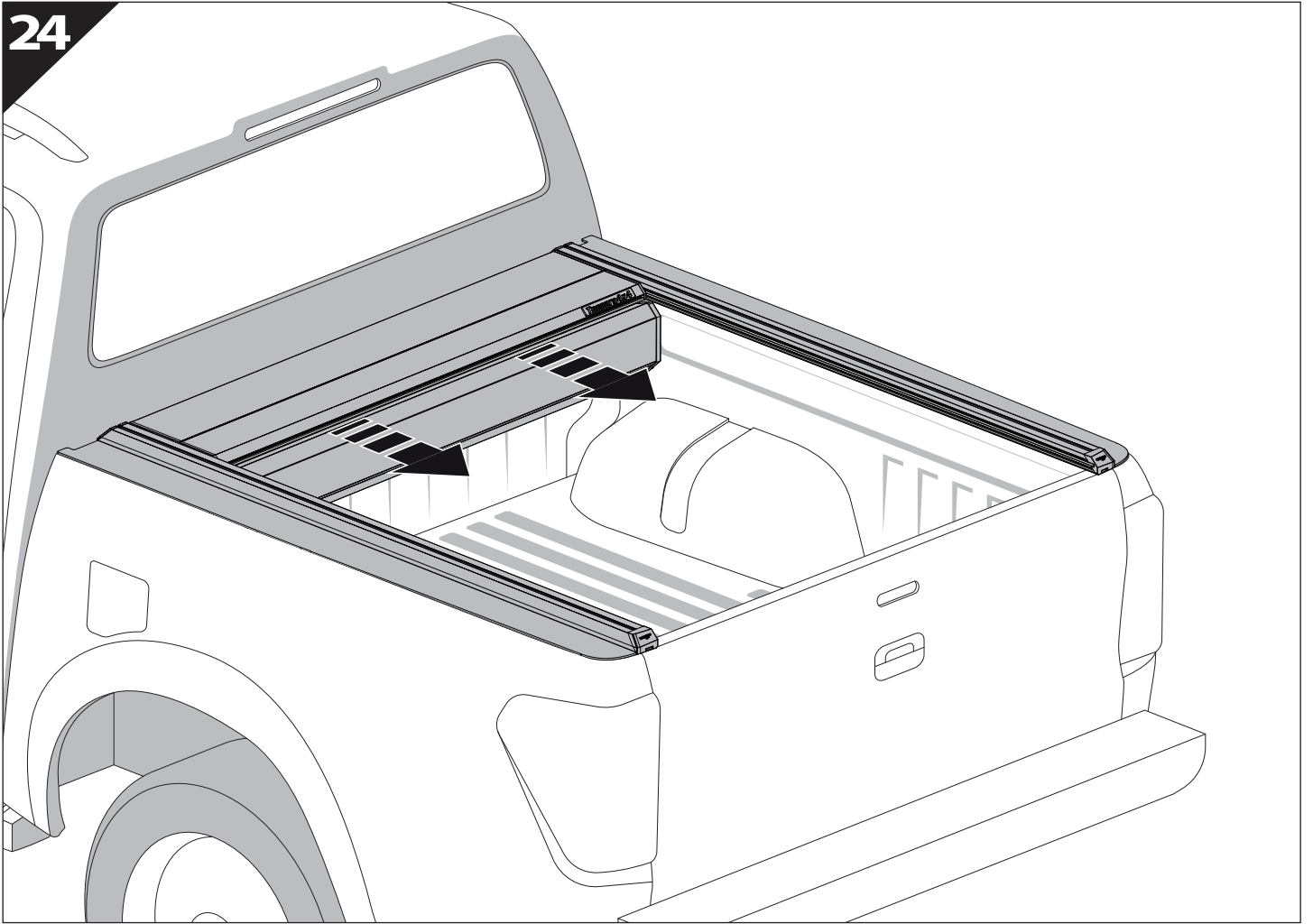

25

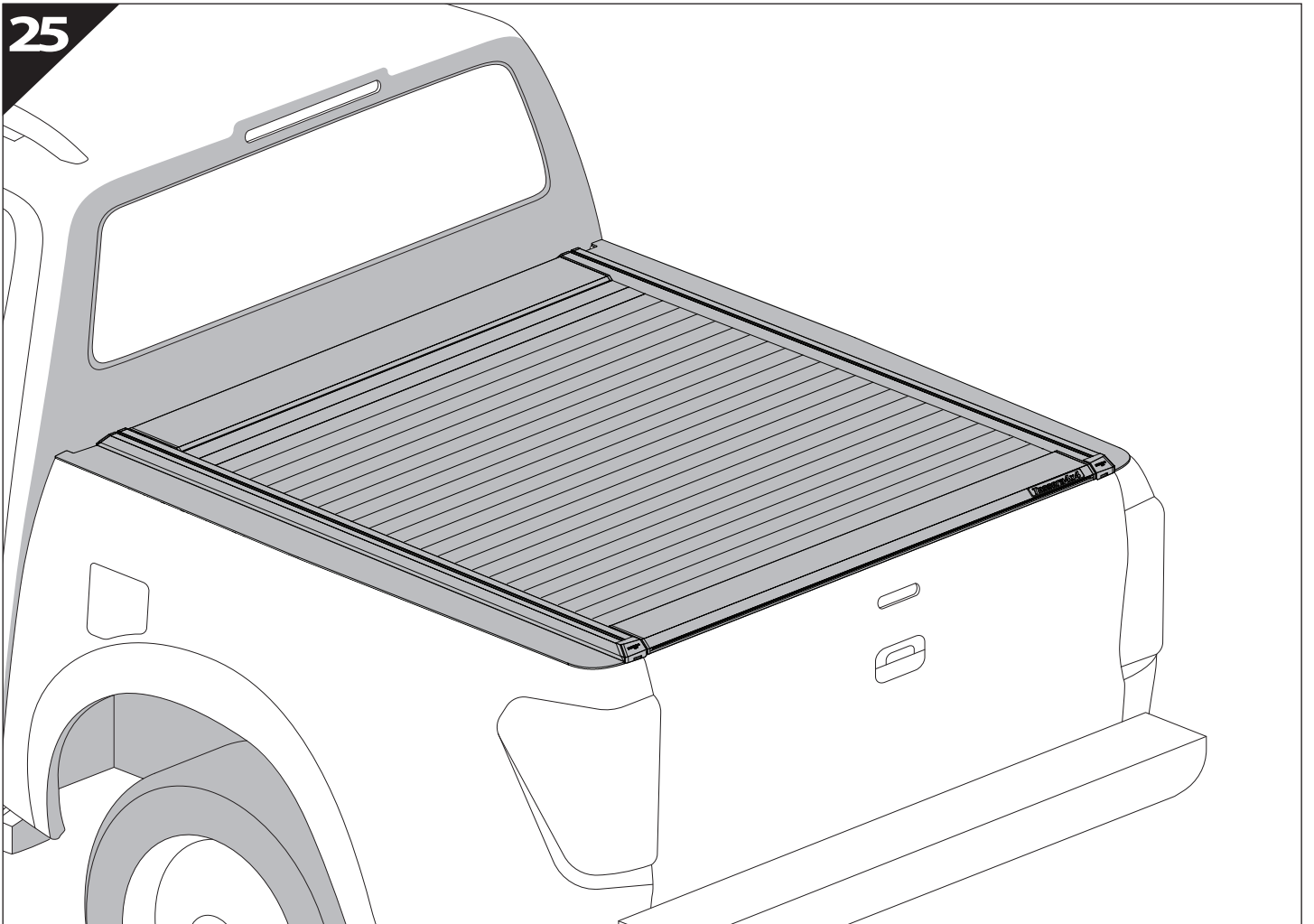



GR: Οδηγίες Εγκατάστασης
GB: Installation manual
SF: Asennusohje
F: Notice de montage
PL: Instrukcja montażu
NL: Installatie-instructies
TR: Montaj Talimatı
S: Monteringsanvisning
E: Instrucciones de montaje

H: Szerelési utasítás
P: Instruções de instalação
RUS: Инструкция по установке
N: Monteringsveiledning
D: Einbauanleitung
CZ: Návod k instalaci
I: Istruzioni de montaggio
DK: Monteringsvejledning
RO: Instructiuni de instalare

Customer Service:

+30 (210) 5541161, +30 (210) 5541154 (08:00 - 16:00 EET)

Support department:

info@gianso.gr

Website:

www.tessera4x4.com

Address:

19.5 km of National road Athens-Korinthos (Elefsina) Greece, P.C: 19200